

2VV-33C-R4-V6



8-port multibeam antenna, 8x 1695–2690 MHz, 4x 33° HPBW, 4x RET, has tilt scales

- Enhances network capacity and spectrum utilization when used in six sector applications
- Reduces antenna count to minimize Cap-Ex and Op-Ex costs – 3 antennas required for 6 sector configurations

General Specifications

Antenna Type	Multibeam
Band	Single band
Color	Light Gray (RAL 7035)
Grounding Type	RF connector inner conductor and body grounded to reflector and mounting bracket
Performance Note	Outdoor usage
Radome Material	Fiberglass, UV resistant
Radiator Material	Low loss circuit board
Reflector Material	Aluminum
RF Connector Interface	4.3-10 Female
RF Connector Location	Bottom
RF Connector Quantity, high band	8
RF Connector Quantity, total	8

Remote Electrical Tilt (RET) Information

RET Hardware	CommRET v2
RET Interface	8-pin DIN Female 8-pin DIN Male
RET Interface, quantity	1 female 1 male
Internal RET	High band (4)
Power Consumption, idle state, maximum	2 W
Power Consumption, normal conditions, maximum	10 W
Protocol	3GPP/AISG 2.0 (Single RET)

Dimensions

Width	395 mm 15.551 in
--------------	--------------------

2VV-33C-R4-V6

Depth	228 mm 8.976 in
Length	2499 mm 98.386 in
Net Weight, without mounting kit	29.8 kg 65.698 lb

Array Layout

Array	Freq (MHz)	Conns	RET (SRET)	AISG RET UID
Y1	1695-2690	1-2	1	CPxxxxxxxxxxxxxxxxY1
Y2	1695-2690	3-4	2	CPxxxxxxxxxxxxxxxxY2
Y3	1695-2690	5-6	3	CPxxxxxxxxxxxxxxxxY3
Y4	1695-2690	7-8	4	CPxxxxxxxxxxxxxxxxY4

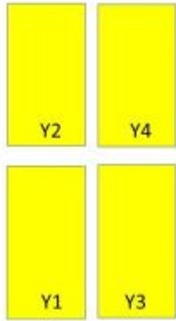

Bottom

(Sizes of colored boxes are not true depictions of array sizes)

Port Configuration

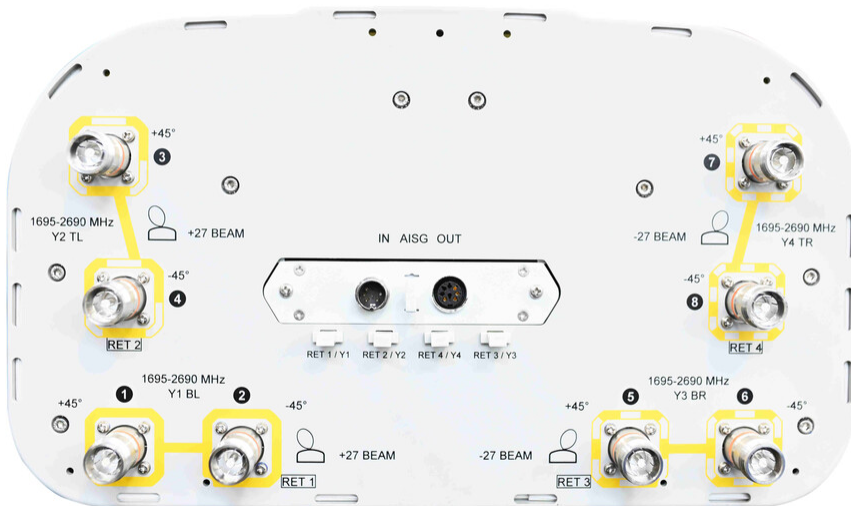

2VV-33C-R4-V6

Electrical Specifications

Impedance	50 ohm
Operating Frequency Band	1695 – 2690 MHz
Polarization	±45°
Total Input Power, maximum	1,200 W @ 50 °C

Electrical Specifications

Frequency Band, MHz	1695–1880	1850–1990	1920–2180	2300–2500	2500–2690
Gain, dBi	19.1	19.3	19.2	19.6	19.6
Beam Centers, Horizontal, degrees	±27	±27	±27	±27	±27
Beamwidth, Horizontal, degrees	39	38	37	34	31
Beamwidth, Vertical, degrees	7.8	7.3	7	6.2	5.8
Beam Tilt, degrees	2–12	2–12	2–12	2–12	2–12
Horizontal Sidelobe, dB	19	20	20	18	17
USLS (First Lobe), dB	15	15	15	18	18
Front-to-Back Ratio at 180°, dB	33	39	39	36	32
Isolation, Cross Polarization, dB	30	30	30	30	30
VSWR Return loss, dB	1.4 15.6	1.4 15.6	1.4 15.6	1.4 15.6	1.4 15.6
PIM, 3rd Order, 2 x 20 W, dBc	-153	-153	-153	-153	-153
Input Power per Port at 50°C, maximum, watts	200	200	200	200	200

Electrical Specifications, BASTA

Frequency Band, MHz	1695–1880	1850–1990	1920–2180	2300–2500	2500–2690
Gain by all Beam Tilts, average, dBi	18.6	18.9	19.1	19.2	19.3
Gain by all Beam Tilts Tolerance, dB	±0.7	±0.5	±0.6	±0.4	±0.5
Gain by Beam Tilt, average, dBi	2° 18.7 7° 18.6 12° 18.4	2° 19.1 7° 19.0 12° 18.6	2° 19.3 7° 19.2 12° 18.8	2° 19.2 7° 19.3 12° 19.0	2° 19.3 7° 19.4 12° 19.1
Beamwidth, Horizontal Tolerance, degrees	±2.4	±1.7	±2.5	±2.4	±1.8
Beamwidth, Vertical	±0.4	±0.3	±0.4	±0.3	±0.2

2VV-33C-R4-V6

Tolerance, degrees

USLS, beampeak to 20° above beampeak, dB	15	15	15	18	18
Front-to-Back Total Power at 180° ± 30°, dB	24	27	28	29	28
CPR at Boresight, dB	23	26	25	23	20
CPR at 10 dB Horizontal Beamwidth, dB	13	13	12	9	9

Mechanical Specifications

Effective Projective Area (EPA), frontal	0.49 m ² 5.274 ft ²
Effective Projective Area (EPA), lateral	0.36 m ² 3.875 ft ²
Wind Loading @ Velocity, frontal	525.0 N @ 150 km/h (118.0 lbf @ 150 km/h)
Wind Loading @ Velocity, lateral	386.0 N @ 150 km/h (86.8 lbf @ 150 km/h)
Wind Loading @ Velocity, maximum	898.0 N @ 150 km/h (201.9 lbf @ 150 km/h)
Wind Loading @ Velocity, rear	540.0 N @ 150 km/h (121.4 lbf @ 150 km/h)
Wind Speed, maximum	241 km/h (150 mph)

Packaging and Weights

Width, packed	505 mm 19.882 in
Depth, packed	386 mm 15.197 in
Length, packed	2631 mm 103.583 in
Weight, gross	43.8 kg 96.562 lb

Regulatory Compliance/Certifications

Agency	Classification
CHINA-ROHS	Above maximum concentration value
ISO 9001:2015	Designed, manufactured and/or distributed under this quality management system
ROHS	Compliant/Exempted
UK-ROHS	Compliant/Exempted



Included Products

BSAMNT-3	–	Wide Profile Antenna Downtilt Mounting Kit for 2.4 - 4.5 in (60 - 115 mm) OD round members. Kit contains one scissor top bracket set and one bottom bracket set.
----------	---	--

2VV-33C-R4-V6

* Footnotes

Performance Note

Severe environmental conditions may degrade optimum performance