

Cable Blocking Kit for EHD Chassis

ACCESS WITH SMARTPHONE FOR EHD USER MANUAL AND FIBER CONNECTOR CLEANING INSTRUCTIONS

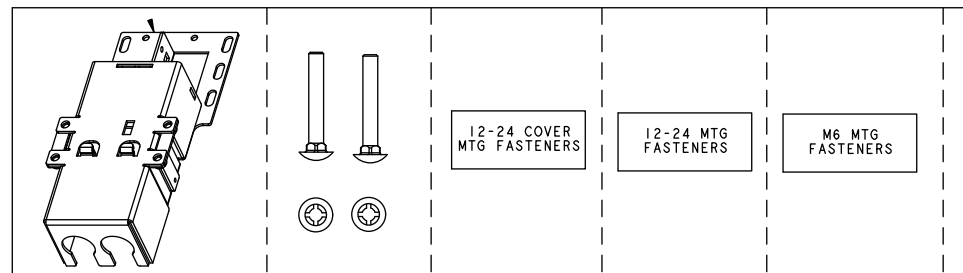

KIT COMPONENTS



CABLE BRACKET, CABLE MOUNTING BOLTS & PLASTIC WASHERS, COVER FASTENERS, 12-24 FASTENERS (FASTENERS FOR CABLE BRACKET), M6 FASTENERS

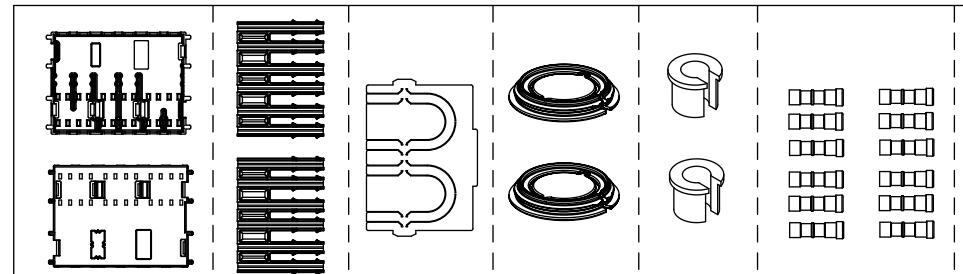

MESH RETAINER COVERS, MESH FORKS, CABLE ENTRY PLATE, CONVOLUTED TUBING GROMMETS, CABLE GROMMETS, FIBER SLEEVES

NOTE: NOT SHOWN: ● PLASTIC BAG WITH PROTECTIVE MESH; ● PLASTIC BAG WITH CONVOLUTED TUBING; ● PACKAGE OF MISCELLANEOUS HARDWARE INCLUDING CABLE CLAMP HALVES, WASHER, NUT, & OPTIONAL-USE CABLE GROUNDING HARDWARE.

TOOLS REQUIRED



1

Measure and strip cable.

Refer to diagram below for dimensions. Break out the cable, as follows:

- From cable stub end, measure out 75 to 78 inches (190.5 to 198.12cm);
- Add length from cable mount to EHD chassis entry;
- Break out cable at this location.

Prepare one piece of protective mesh for each two ribbons, as follows:

- Measure out length of 30-33 in. (76.2-83.8cm);
- Add length from cable mount to EHD chassis entry;
- Cut mesh at this location.



Stripping back cable



Cutting protective mesh

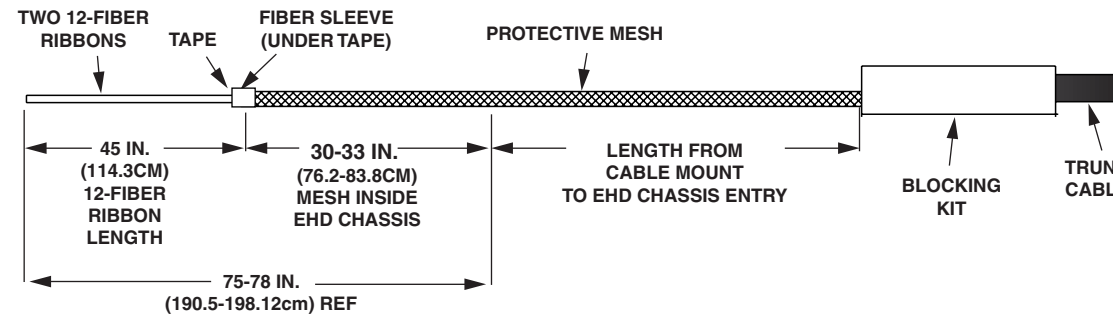

2

Mount cable bracket and cable clamp.

Install cable bracket on frame using two screws provided. Install cable clamp on cable guide, stacking components in order shown. Use cable grommets as needed to ensure snug fit within cable clamp. Tighten cable clamp nut using nut driver or can wrench only (no ratchets or power tools). Do not overtighten.

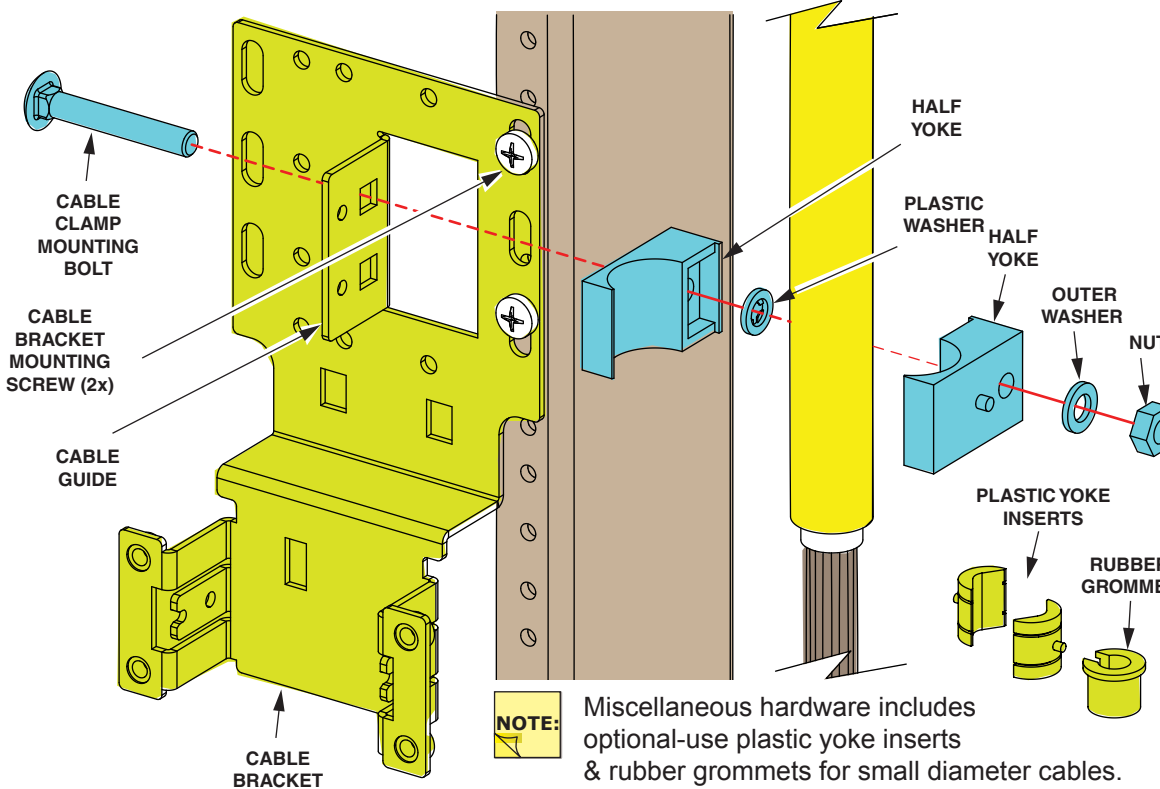

NOTE: Miscellaneous hardware includes optional-use plastic yoke inserts & rubber grommets for small diameter cables.

3

Install mesh sleeve onto fork, place fork with mesh in one cover, and place the other cover on top (enclosing fork and mesh between the two covers).

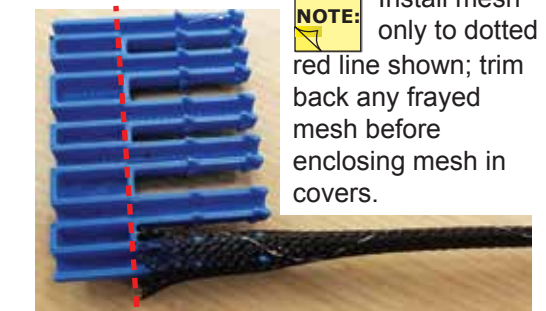

NOTE: Install mesh only to dotted red line shown; trim back any frayed mesh before enclosing mesh in covers.

Installing mesh sleeve on fork



Placing fork (with mesh) in cover

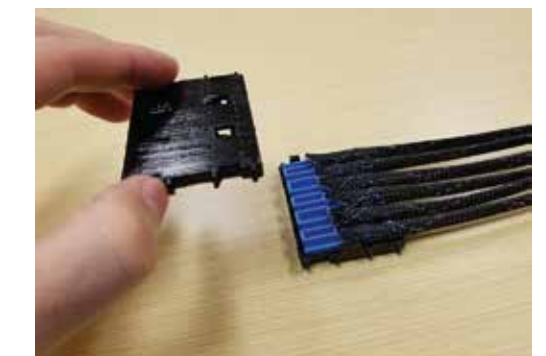

Placing second cover on top



Completed mesh retainer

4 Snap the mesh retainer into the cable clamp, draping ribbons to outside.

5 In numerical order, take two ribbons at a time, join ends with tape, and insert pair into the correct retainer slot. (For clarity the retainer is shown here in white.)

NOTE: Ends of fiber ribbons MUST be taped up to prevent them from fraying when inserted into the mesh.

TRIM RIBBONS IF NECESSARY

6 Break out a section of the cable entry plate for passage of the cable. Install the protective plate and cable entry plate on the cable bracket.

BROKEN OUT SECTION OF CABLE ENTRY PLATE

FOR CLARITY, RIBBON FIBERS ARE NOT SHOWN IN THIS VIEW.

7 Secure plate with screws provided (12-24).

8 Remove gland molding at cable entry, thread mesh into chassis, and install convoluted tubing on mesh.

REMOVE GLAND MOLDING FROM CABLE ENTRY

9 Secure convoluted tubing to blocking kit and attach at chassis entry using convoluted tubing grommet (shown at right).

CONVOLUTED TUBING ON MESH

10 On the chassis end of each taped fiber pair, slip a fiber sleeve into the mesh and secure with vinyl tape.

PROTECTIVE MESH

VINYL TAPE

FIBER SLEEVE

11 Fiber ribbon is now ready for termination to splice module. See splice cassette installation instructions.