

# MTC401560HCS

---

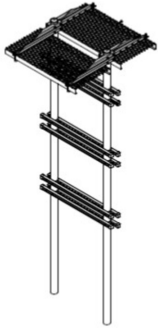

H-Frame with Ice Canopy, 5ft long with 2 Base Shoe Posts

## Product Classification

**Product Type** Ice canopies and shields

## Dimensions

**Height** 3,225.8 mm | 127 in

**Width** 1524 mm | 60 in

**Length** 1,460.5 mm | 57.5 in

## Material Specifications

**Material Type** Hot dip galvanized steel

## Packaging and Weights

**Included** Hardware | Ice shield | Legs | Unistrut

**Packaging quantity** 1

**Weight, net** 167.6 kg | 369.494 lb

## Regulatory Compliance/Certifications

### Agency

ISO 9001:2015

### Classification

Designed, manufactured and/or distributed under this quality management system



## Included Products

MF-130 – Direct Burial Pipe Column, 13 ft 4 in

# MF-130

---

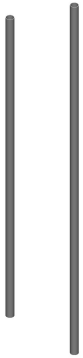

Direct Burial Pipe Column, 13 ft 4 in

## Product Classification

**Product Type** Pipe column

## General Specifications

**Application** Direct burial  
**Mounting** Waveguide bridge support bracket  
**Pipe, quantity** 1

## Dimensions

**Height** 4064 mm | 160 in  
**Width** 88.9 mm | 3.5 in  
**Length** 88.9 mm | 3.5 in  
**Pipe Length** 4,053.84 mm | 159.6 in  
**Pipe Outer Diameter** 88.9 mm | 3.5 in

# MF-130

## Outline Drawing

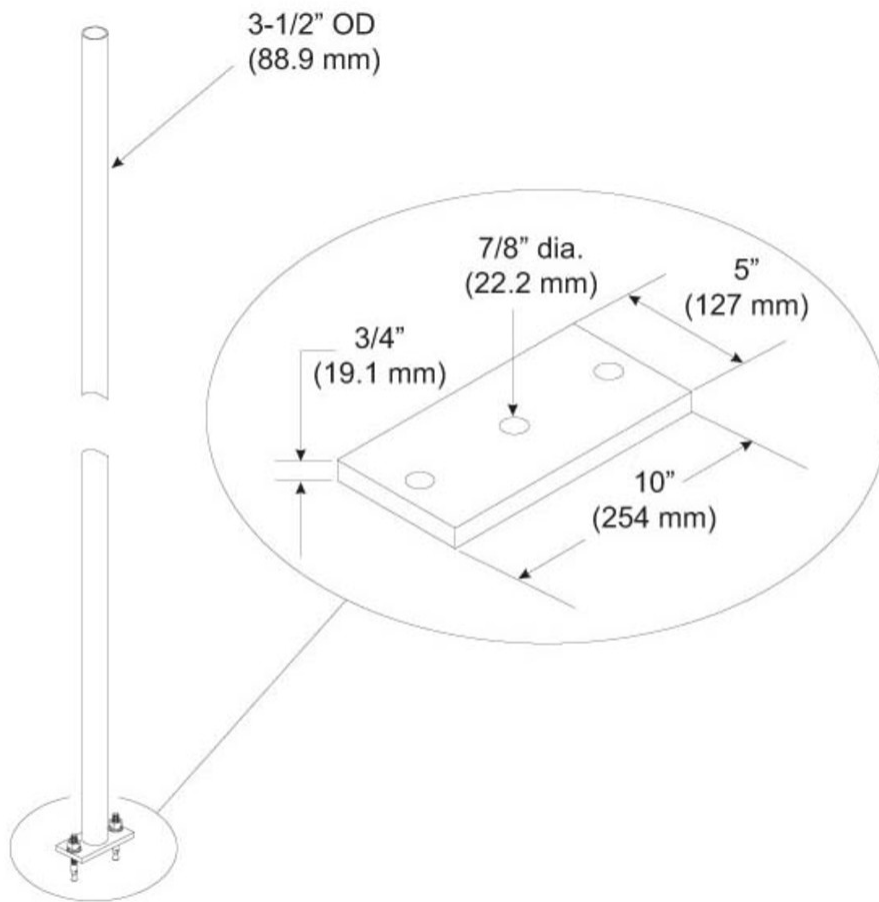

## Material Specifications

**Material Type** Hot dip galvanized steel

## Packaging and Weights

**Included** Anchors | Pipe

**Packaging quantity** 1

**Weight, net** 45.8 kg | 100.972 lb

## Regulatory Compliance/Certifications

**Agency** **Classification**

# MF-130

---

ISO 9001:2015

Designed, manufactured and/or distributed under this quality management system

