

QWIK II SC/LC/ST CONNECTOR - BASIC TOOLKIT

Contents

1	General.....	1	5	2mm/3mm Cable Termination.....	5
2	250µm Fiber Termination	2	6	Troubleshooting	6
3	900µm Fiber Termination	3	7	Support Center and Product Patents	6
4	900µm Fanout/Breakout Fiber Termination.....	4	8	QR Codes.....	6

1. General

These installation instructions provide termination procedures for the Qwik II SC, LC and ST connectors, which allow termination on 250µm, 900µm tight-buffered, 900µm fanout/breakout kit, and 2mm-3mm cable.

NOTE: DO NOT use these instructions to install previous versions of QWIK SC, LC and ST connectors.

WARNING: Always wear eye protection when handling optical fibers. Dispose of cut or cleaved ends properly.

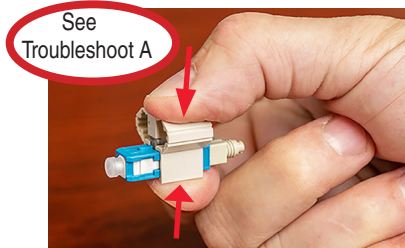
The toolkit includes the components identified in Figure 1. This same callout numbers are referenced within parentheses in the procedures.

1. Fiber Clamp (Black) - 900µm
2. Fiber Clamp (Green) - 3mm
3. Fiber Clamp (Blue) - 2mm
4. Strip Length Template
5. Marker
6. Fiber Stripper
7. Scissors
8. Trash Can
9. Fiber Cleaver
10. Lint-Free Cloth Wipes
11. Fiber Preparation Fluid

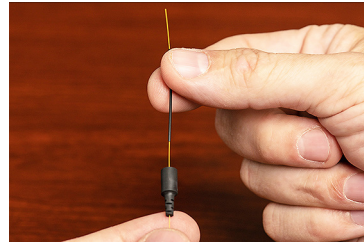


Figure 1. Basic Toolkit Components

2. 250 μ m Fiber Termination



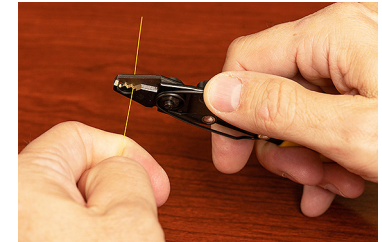
1: Critical - Ensure wedge clip is fully engaged by squeezing top and bottom of clip together. Two clicks may be heard if it became disengaged during shipment



2: Slide the 900 μ m boot and the 250 μ m protective tubing onto the fiber.



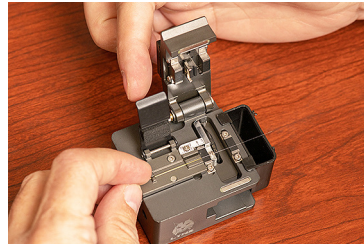
3: Reference the Strip Length Template (4), mark at 40mm strip mark.



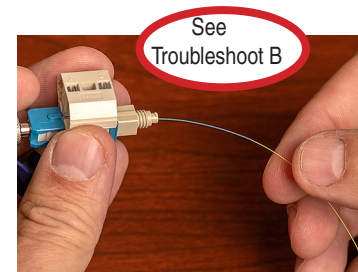
4: Strip off 40mm of the 250 μ m coating. Check the fiber integrity by bending the stripped end slightly at 60°.



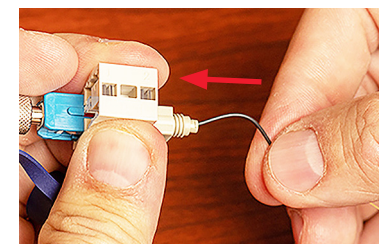
5: Clean the stripped fiber with a lint-free cloth wipe (10) and fiber preparation fluid (11) to remove any debris.



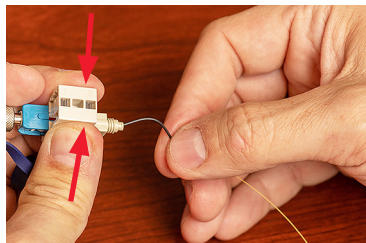
6: Set the stripped fiber onto the fiber cleaver (9) such that the 250 μ m coating's edge is between 10mm to 11mm position. Cleave once the fiber is in proper position.



7: Insert the cleaved fiber into the rear of the connector. Once the fiber is fully inserted, slide the 250 μ m protective tubing into the connector until it stops.



8: While holding the fiber and tubing, make a slight bend by pushing the fiber toward the connector to maintain contact.

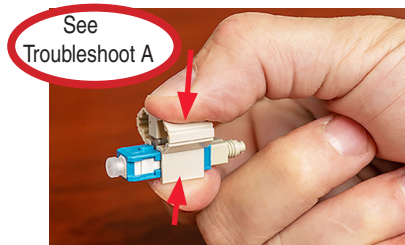


9. Activate the splice and remove the wedge clip from connector by squeezing both sides of the clip. Both fiber and tube should be captured.

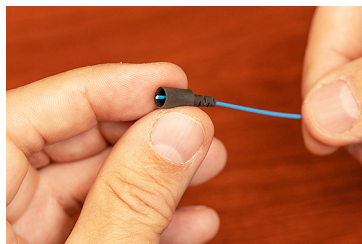


10: Push the boot on completely and termination is complete.

3. 900 μ m Fiber Termination



1: Critical - Ensure wedge clip is fully engaged by squeezing top and bottom of clip together. Two clicks may be heard if it became disengaged during shipment



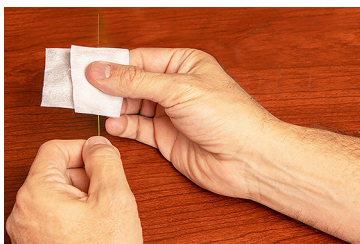
2: Slide the 900 μ m boot onto the fiber.



3: Reference the Strip Length Template (4) and mark at two locations: Strip Length Mark (at 40mm) and Connector Mark (at 11.5mm for LC or at 15.5mm for SC/ST).



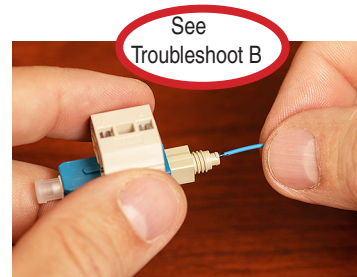
4: Strip off 40mm of the 900 μ m buffer and the 250 μ m coating to Strip Length Mark (first mark from the end of fiber) by stripping off in 10mm sections.



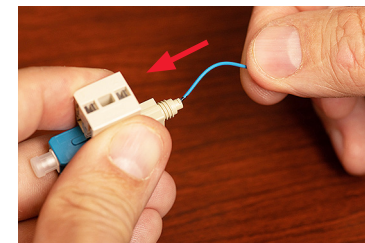
5: Check the fiber integrity by bending the stripped end slightly at 60°. Clean the stripped fiber with a lint-free cloth wipe (10) and fiber preparation fluid (11) to remove any debris.



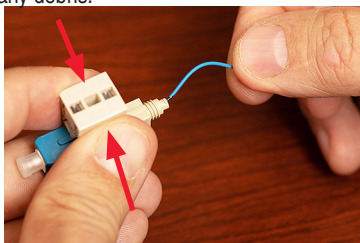
6: Set the stripped fiber onto the fiber cleaver (9) such that the 900 μ m buffered fiber's edge is between 10mm to 11mm position. Cleave once the fiber is in proper position.



7: Insert the cleaved fiber into the rear of the connector. Once the fiber is fully inserted, the connector mark should be aligned with the rear edge of the connector.



8: While holding the fiber, make a slight bend by pushing the fiber toward the connector to maintain contact.

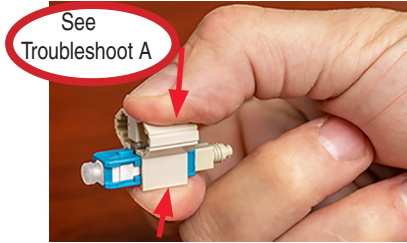


9. Activate the splice and remove the wedge clip from connector by squeezing both sides of the clip.

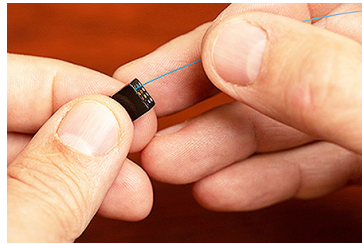


10. Push the boot on completely and termination is complete

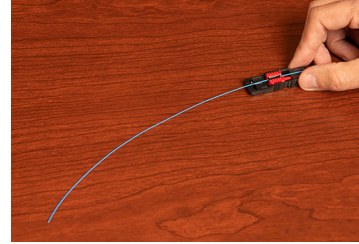
4. 900µm Fanout/Breakout Fiber Termination



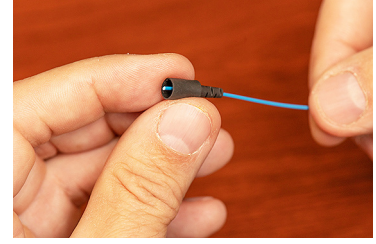
1: Critical - Ensure the wedge clip is fully engaged by squeezing top and bottom of clip together. Two clicks may be heard if it became disengaged during shipment.



2. When using the 900µm Fanout/Breakout kit to upjacket 250µm fiber, follow manufacturer's instructions. After kit is installed, proceed to Qwik II termination.



3. Place the 900µm cable clamp (1) 10 inches from end of the fiber. Slide clamp forward to lock.



4: Slide the 900µm boot onto the fiber.



5. Reference the Strip Length Template (4) and mark at two locations: Strip Length Mark (at 40mm) and Connector Mark (at 11.5mm for LC or at 15.5mm for SC/ST).



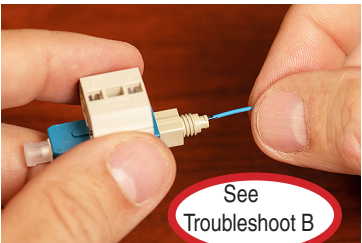
6: Strip off 40mm of the 900µm buffer and the 250µm coating to Strip Length Mark (first mark from the end of fiber) by stripping off in 10mm sections.



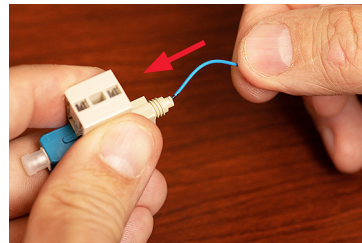
7: Check the fiber integrity by bending the stripped end slightly at 60°. Clean the stripped fiber with a lint free cloth wipe (10) and fiber preparation fluid (11) to remove any debris.



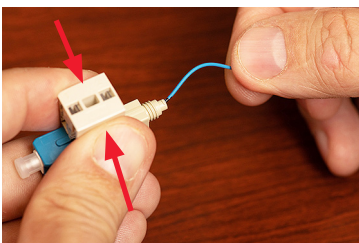
8: Set the stripped fiber onto the fiber cleaver (9) such that the 900µm buffered fiber's edge is between 10mm to 11mm position. Cleave once the fiber is in proper position.



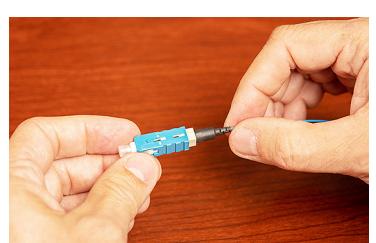
9: Insert the cleaved fiber into the rear of the connector. Once the fiber is fully inserted, the connector mark should be aligned with the rear edge of the connector.



10: While holding the fiber, make a slight bend by pushing the fiber toward the connector to maintain contact.



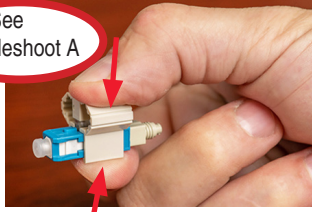
11: Activate the splice and remove the wedge clip from connector by squeezing both sides of the clip.



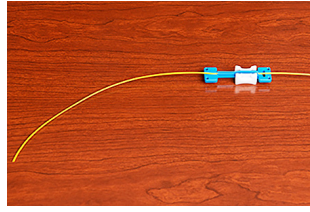
12. Push the boot on completely and termination is complete.

5. 2mm/3mm Cable Termination

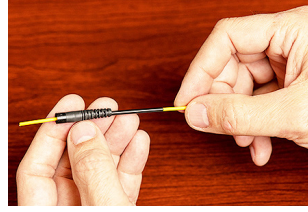
See
Troubleshoot A



1: **Critical** - Ensure wedge clip is fully engaged by squeezing top and bottom of clip together. Two clicks may be heard if it became disengaged during shipment.



2. Place the appropriate cable clamp 10 inches from end of cable. Blue clamp (3) for 2mm and green clamp (2) for 3mm. Slide the clamp forward to lock.



3. Slide the appropriate boot onto the fiber.



4: Reference the Strip length Template (4) and mark at 75mm. Strip off 75mm of the cable jacket.



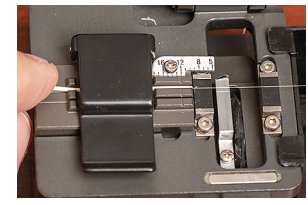
5: Reference the Strip Length Template (4) and mark two locations: Strip Length Mark (at 40mm) and Connector Mark (at 11.5mm for LC or at 15.5mm for SC/ST).



6: Strip off 40mm of the 900µm buffer and the 250µm coating to Strip Length Mark (first mark from the end of fiber) by stripping off in 10mm sections.

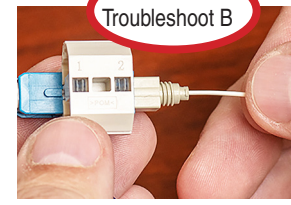


7: Check the fiber integrity by bending the stripped end slightly at 60°. Clean the stripped fiber with a lint free cloth wipe (10) and finer preparation fluid (11) to remove any debris.

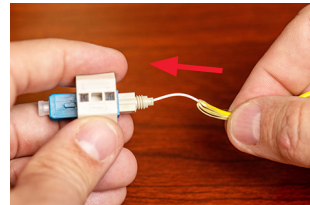


8: Set the stripped fiber onto the fiber cleaver (9) such that the 900µm buffered fiber's edge is between 10mm to 11mm position. Cleave once the fiber is in proper position.

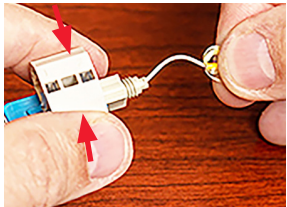
See
Troubleshoot B



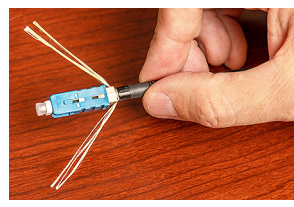
9: Insert the cleaved fiber into the rear of the connector. Once the fiber is fully inserted, the connector mark should be aligned with the rear edge of the connector.



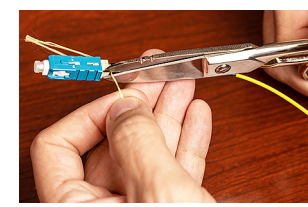
10: While holding the fiber, make a slight bend by pushing the fiber toward the connector to maintain contact.



11: Activate the splice and remove the wedge clip from connector by squeezing both sides of the clip.



12: Divide the Kevlar evenly on both sides. Pull the Kevlar tightly and thread the boot on halfway.



13: Trim excess Kevlar using the Kevlar scissors (7).



14: Thread the boots on tightly. Termination is complete.

6 Troubleshooting

Below are troubleshooting strategies for balloon references within the installation procedures.

A

If unsure the wedge clip is fully engaged, completely disengage the clip by squeezing both sides until the clip is dislocated. Re-position connector into the wedge clip and then re-engage the clip by squeezing the top and bottom of the clip together. Two clicks should be heard.

B

If the fiber cannot be fully inserted, follow Troubleshoot A to ensure wedge clip is fully engaged.

7 Support Center and Product Patents

Support Center

<https://www.commscope.com/SupportCenter>

CommScope Product Patents

<https://www.commscope.com/ProductPatents/ProductPatents.aspx>

CommScope Website

<http://www.commscope.com>

8 QR Codes



Product
Information



Installation
Videos

COMMSCOPE®