

# FAWLCUC01

---

## Base Product

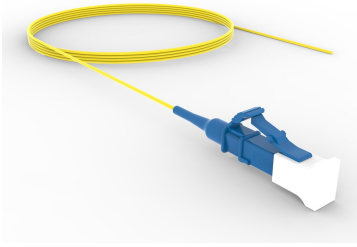

TeraSPEED® LC/UPC to Unconnectorized, Fiber Pigtail, 0.9 mm Tight Buffer

## Product Classification

<b>Regional Availability</b>	Asia   Australia/New Zealand   China   Europe   India   Latin America   Middle East/Africa   North America
<b>Portfolio</b>	CommScope®
<b>Product Type</b>	Fiber pigtail, unjacketed
<b>Product Brand</b>	SYSTIMAX InstaPATCH® 360
<b>Product Series</b>	FAW
<b>Ordering Note</b>	Minimum length may vary based on cable configuration

## General Specifications

<b>Color, boot A</b>	Blue
<b>Color, connector A</b>	Blue
<b>Interface, Connector A</b>	LC/UPC
<b>Jacket Color</b>	Yellow
<b>Total Fibers, quantity</b>	1

## Dimensions

<b>Cable Assembly Length Range (m)</b>	1 – 20
<b>Cable Assembly Length Range (ft)</b>	1 – 66

## Ordering Tree

# FAWLCUC01

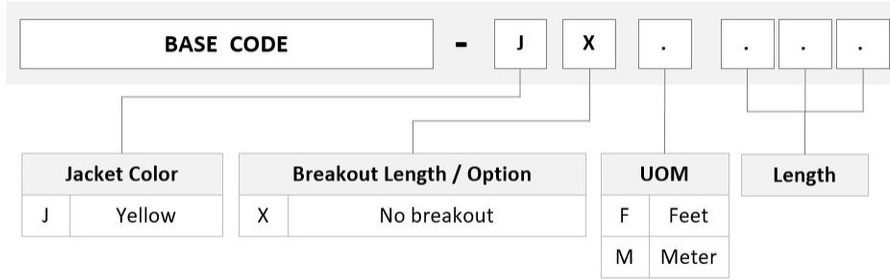

## Mechanical Specifications

**Cable Retention Strength, maximum** 1.00 lb @ 0 ° | 1.00 lb @ 90 °

## Optical Specifications

**Fiber Mode** Singlemode

**Fiber Type** G.652.D | G.657.A1, TeraSPEED®

## Environmental Specifications

**Operating Temperature** -10 °C to +60 °C (+14 °F to +140 °F)

**Environmental Space** Unrated

## Packaging and Weights

**Packaging quantity** 2

## Regulatory Compliance/Certifications

Agency	Classification
ANATEL	Compliant
CHINA-ROHS	Below maximum concentration value
ISO 9001:2015	Designed, manufactured and/or distributed under this quality management system
REACH-SVHC	Compliant as per SVHC revision on <a href="http://www.commscope.com/ProductCompliance">www.commscope.com/ProductCompliance</a>
ROHS	Compliant
UK-ROHS	Compliant



## Included Products

# FAWLCUC01

---

- 760038570 - TeraSPEED® 900µm Tight Buffered Fiber
- X-TB-8W-YL-F/G
- 860657283 - LC/UPC Connector, Singlemode, Blue

## TeraSPEED® 900µm Tight Buffered Fiber

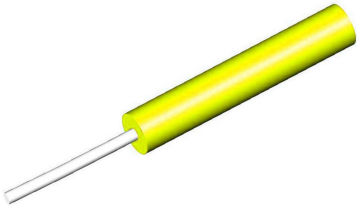

### Product Classification

<b>Regional Availability</b>	Asia   Australia/New Zealand   EMEA   Latin America   North America
<b>Portfolio</b>	CommScope®
<b>Product Type</b>	Fiber indoor cable

### Representative Image

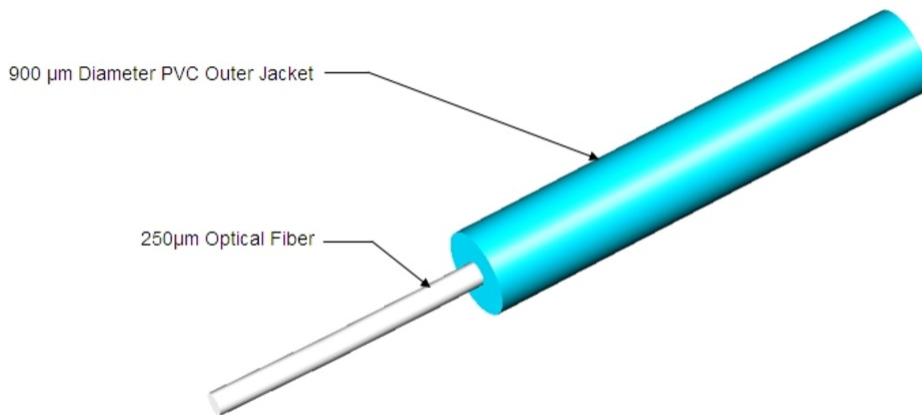

### Regulatory Compliance/Certifications

<b>Agency</b>	<b>Classification</b>
CHINA-ROHS	Below maximum concentration value
ISO 9001:2015	Designed, manufactured and/or distributed under this quality management system
REACH-SVHC	Compliant as per SVHC revision on <a href="http://www.commscope.com/ProductCompliance">www.commscope.com/ProductCompliance</a>
ROHS	Compliant
UK-ROHS	Compliant



## LC/UPC Connector, Singlemode, Blue

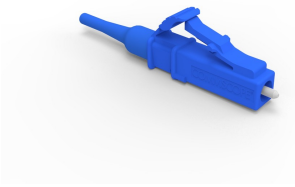

### Product Classification

<b>Regional Availability</b>	Asia   Australia/New Zealand   EMEA   Latin America   North America
<b>Portfolio</b>	CommScope®
<b>Product Type</b>	Fiber connector

### General Specifications

<b>Color, boot</b>	Blue
<b>Color, housing</b>	Blue
<b>Interface</b>	LC/UPC

### Dimensions

<b>Length</b>	39.6 mm   1.559 in
<b>Compatible Cable Diameter</b>	0.9 mm   0.035 in

### Material Specifications

<b>Ferrule Material</b>	Zirconia
-------------------------	----------

### Mechanical Specifications

<b>Cable Retention Strength, maximum</b>	1.00 lb @ 0 °
--	---------------

### Optical Specifications

<b>Fiber Mode</b>	Singlemode
<b>Insertion Loss Change, mating</b>	0.2 dB
<b>Optical Components Standard</b>	ANSI/TIA-568. 3-D   IEC 61753-1
<b>Insertion Loss Change, temperature</b>	0.2 dB
<b>Insertion Loss, maximum</b>	0.34 dB
<b>Return Loss, minimum</b>	50 dB

## Regulatory Compliance/Certifications

<b>Agency</b>	<b>Classification</b>
CHINA-ROHS	Below maximum concentration value
REACH-SVHC	Compliant as per SVHC revision on <a href="http://www.commscope.com/ProductCompliance">www.commscope.com/ProductCompliance</a>
ROHS	Compliant
UK-ROHS	Compliant



### \* Footnotes

**Insertion Loss Change, mating** TIA-568: Maximum insertion loss change after 500 matings

**Insertion Loss Change, temperature** Maximum insertion loss change from -10 °C to +60 °C (+14 °F to +140 °F)