

# MD-SSA6

---

## Tower Leg Mounted Microwave Antenna Channel Support Kit, 72 in

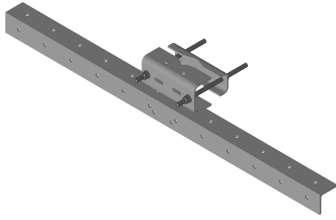

### Product Classification

**Product Type** Microwave strut support

### Dimensions

**Length** 203.2 mm | 8.0 in  
**Width** 1828.8 mm | 72.0 in  
**Height** 152.4 mm | 6.0 in  
**Mounting Diameter, maximum** 203.2 mm | 8 in  
**Weight** 38.6 kg | 85.1 lb

### Environmental Specifications

**Wind Rating** For Specifications, please contact [steelproducts@commscope.com](mailto:steelproducts@commscope.com) or call 800-255-1479

### General Specifications

**Includes** Angle | Attachment hardware | Clamps  
**Material Type** Hot dip galvanized steel  
**Mounting** Straight or tapered legs up to 203.2 mm (8 in) OD  
**Package Quantity** 1  
**Pipe, quantity** 0  
**Tower Taper** Non-tapered

### Regulatory Compliance/Certifications

Agency	Classification
ISO 9001:2015	Designed, manufactured and/or distributed under this quality management system



### \* Footnotes

**Wind Rating** BWS—Base Wind Speed; FBC—Florida Building Code