

AERIAL FAT SPLICING

1 General product information

The Aerial Fiber Access Terminal (FAT) Box (spliced) provides the splicing solution in an access terminal. The terminal has the capacity to splice up to 16 drop cables. Two compact splitters of 8 outputs each can be installed in each (FAT) Box (Spliced).

2 Product images

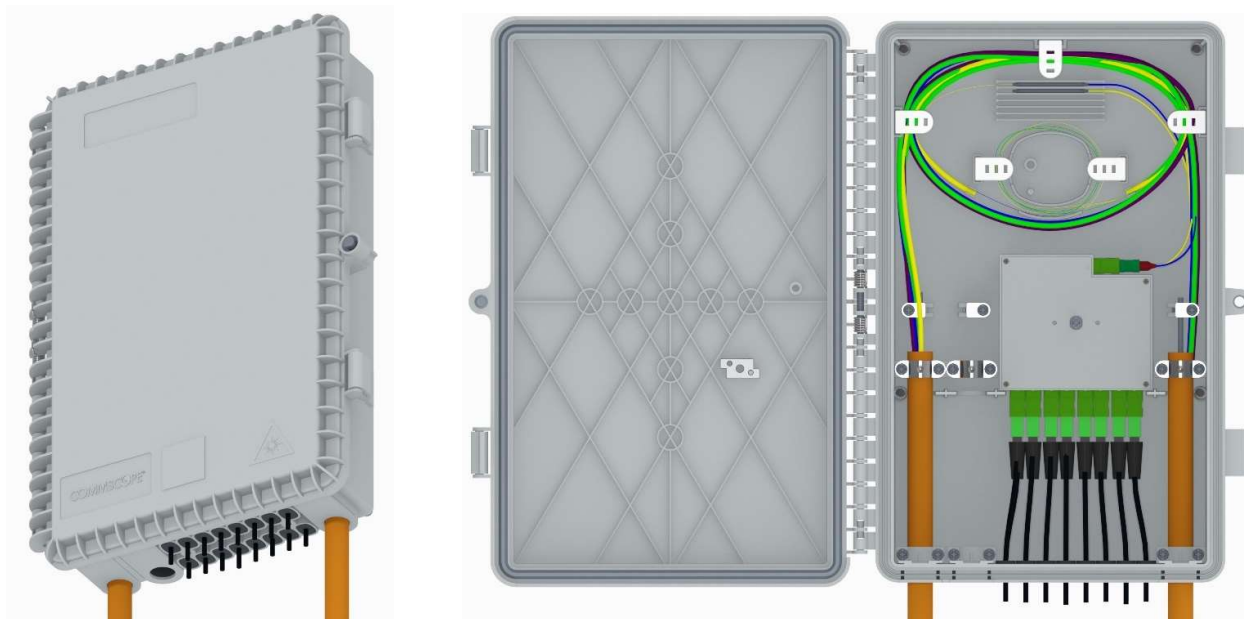

3 Kit contents

Description	Qty	Description	Qty
Cable Storage Clamp	4	Tissue paper	2
SC/APC Pigtail, 1.5m length	1	Sealing Material Silicon Paste	1
Hose Clip 70mmX130mm	2	Cable ties	6
Splice Sleeve Holder	6	Transport tubes 3mm	1
D Key for Cover	1	Torx Security Key	1
Pan Phillips combi. head screw, M4X7	4	Wall Mounting Kit	1

4 Opening/Closing of Aerial FAT box spliced

1. **Loosen cover screw** using the D key provided with the kit.
2. **Open the latch** and hold the stopper for spring loaded cover holding and access home pass area.
3. **Loosen the home pass cover screws** with torx security screw key.
4. **Open the home pass Cover** to access the inner home connect area.

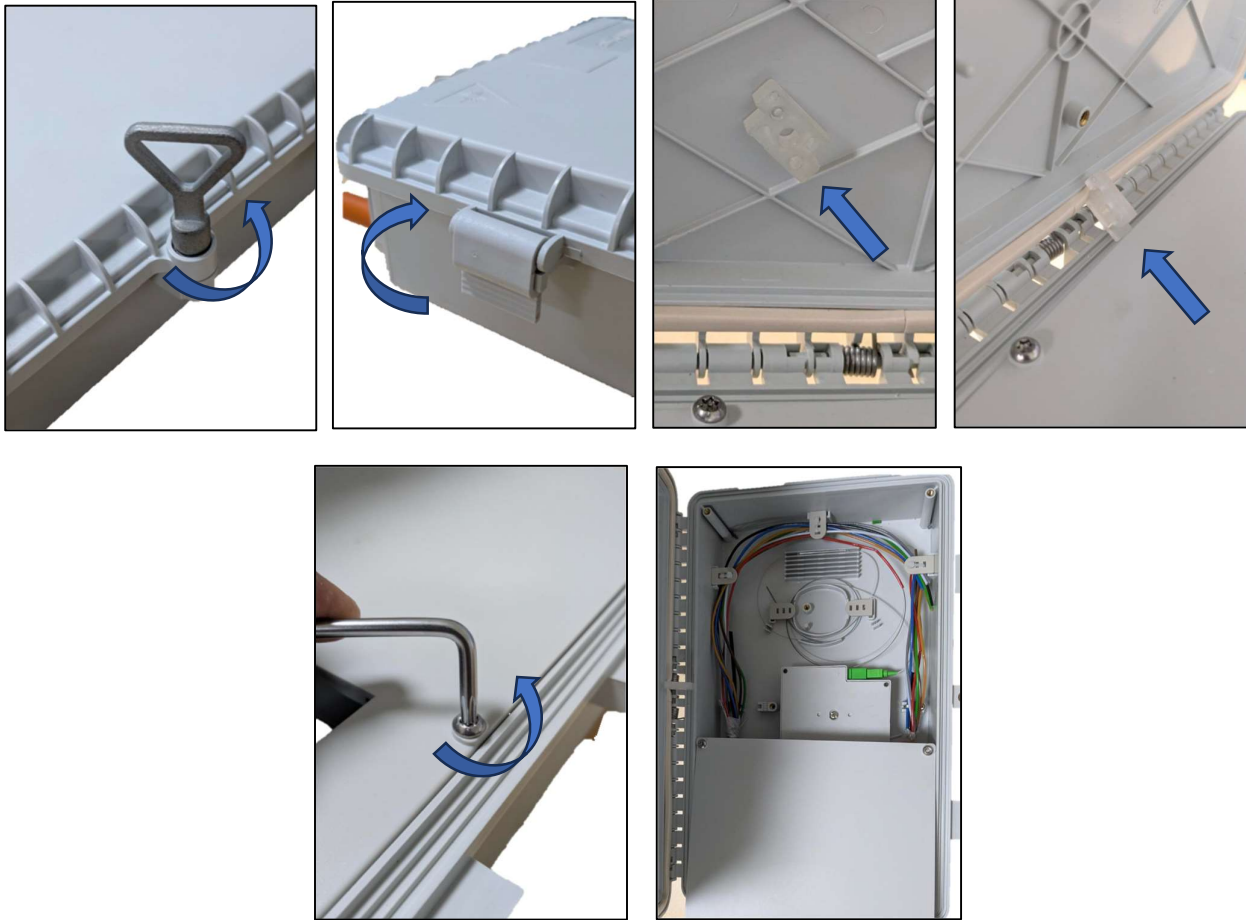

5 Midspan cable entry

1. **Strip the cable** approx. 500mm.
2. **Remove midspan and cable seal** from the midspan port to insert the input cable.
3. **Cut the midspan cable seal** and insert the input cable through it. Different midspan seal types available for 5-8, 8-12 & 12-15mm cable diameter ranges.
4. **Secure cable** with cable retention clamp at cable retention area at input side.
5. **Secure strength member** at the strength member holding area at input side.



6 Routing and splicing inside the home pass area.

1. **Route the loose tubes** below the cable lugs provided from the sides.
2. **Splice the fiber** and hold the splice protection sleeves in the splice holder. (Max capacity is 12 fibers)
3. **Store the 250µm fibers** in the designated home pass storage area. (Put the 250µm fiber in transport tube)
4. **Secure cable** with cable retention clamp at cable retention area at output side.
5. **Secure strength member** at the strength member holding area at output side.
6. **Patch the spliced pigtail** to the splitter input.
7. **Close the home pass cover and lock** with the Torx security screws.
8. **Splitter is now prepared** for the Home Connect application.

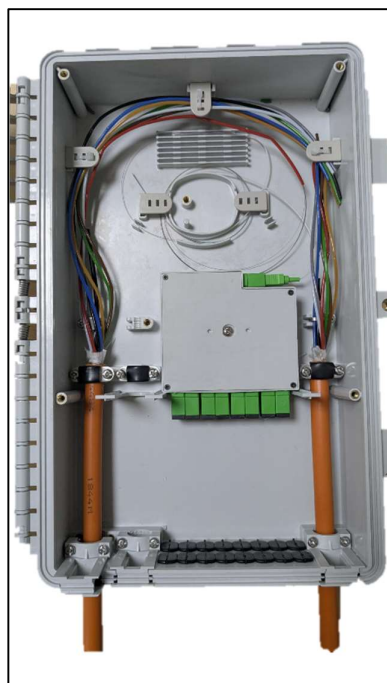

7 Install second compact splitter (Wherever applicable)

1. **Remove center screw** from the compact splitter mounting for double stacked splitter.
2. **Place the compact splitter** at the designated area of the mounting single/double stacked splitter.
3. **Tighten the screw** in the center mounting area of the splitter shown in picture below. (The screw provided with 2nd compact splitter kit)

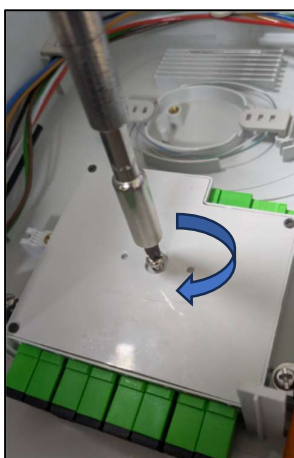

8 Install drop cables

1. **Remove split drop Seal** from the drop port area.
2. **Install the Drop Cables** through the drop ports via split seals.
3. **Patch the Drop cables** with the compact splitter output.
4. **Insert Drop Seal** back in drop port area.
5. **Apply Silicone paste/sealant gel drop** sealing area to maintain Ingress protection. (Full curing time is 24 hours)

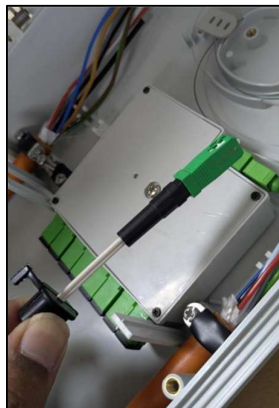

Sealant gel

1 Close the closure

1. **Remove the stopper** and fix it back to the pin provided on the closure cover.
Caution: Release cover slowly/softly as the cover is spring mounted and will auto Close automatically after removal of Stopper. Take care of any object that hinders this movement of the cover like extra fibers, installer's fingers etc. to save them from cuts/pinching.
2. **Close the top cover and tighten the center screw** with the D key.
3. **Latch the plastic latches** to close the cover securely.
4. **Apply silicone paste/sealant gel to drop & feeder sealing area** to maintain Ingress protection. (Full curing time for sealant gel is 24 Hours)

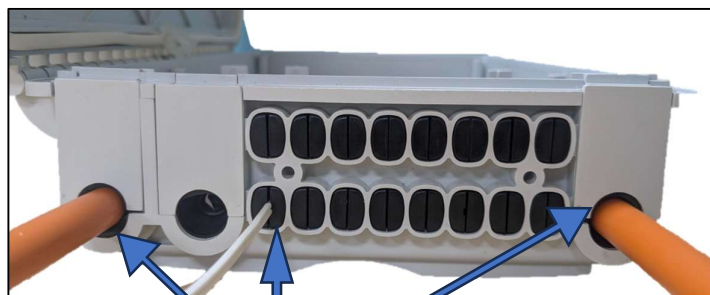
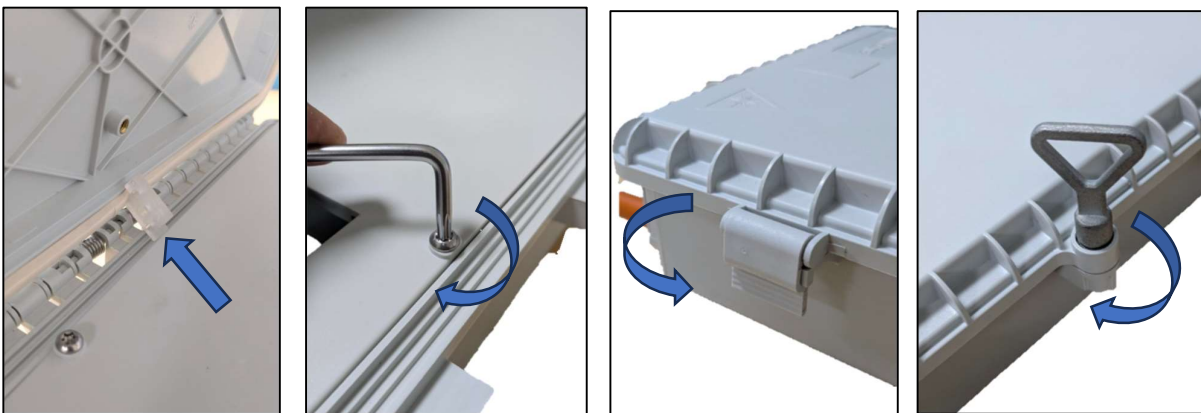

Sealant gel

2 Mount the Closure

A. Wall mounting: where applicable

1. Mark the position of mounting on the wall as indicated below.

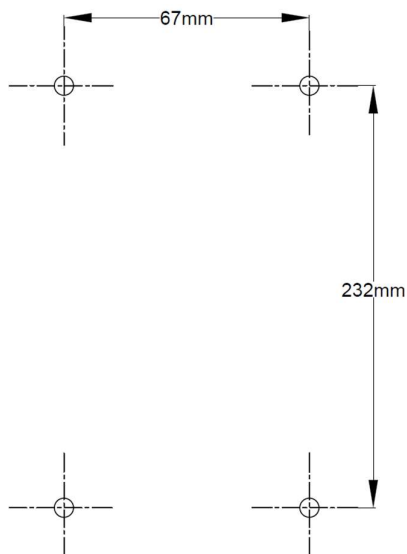

2. Drill 4 holes at the marked position as per screw provided in the kit and insert wall plug.
3. Insert the screws inside the wall plug and keep the 10 mm out of wall.
4. Hang the Aerial FAT spliced box Securely against the wall.

B. Pole mounting: where applicable

1. Open the hose clip and pass it through the slots provided at the back of the Aerial FAT box spliced box.
2. Wrap the clamp around the pole.
3. Assemble the hose as shown in the picture below.

