

MJC Blown Fiber Closure

Gel Closure for Blown Fiber Joint Applications

Features

- Robust construction with high mechanical strength
- Proven gel sealing system:
 - Easy handling at all temperatures
 - Simple re-entry
- Tool-less installation or re-entry
- Closure uses over-centering 'ski boot' type latches
- Integrated mounting brackets for aerial and wall installation
- Cable configuration changes possible with a minimum of extra accessories
- No pressure relief valve required

MJC Blown Fiber Closure

Gel Closure for Blown Fiber Joint Applications

Ordering information

In-Line Closures

	Dimensions			
Number of ports	Length	Width	Height	Ordering number
2	415	71	76	MJC-10/20PR-INL
4	550	124	100	MJC-50/100PR-INL
8	500	155	151	MJC-4/4BF-INL ¹

¹ For blown fiber applications

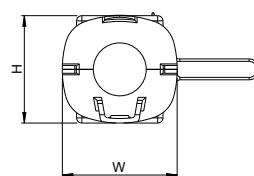
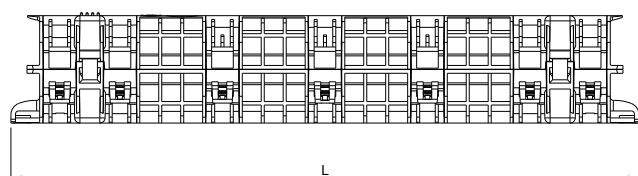

MJC-10/20PR-INL

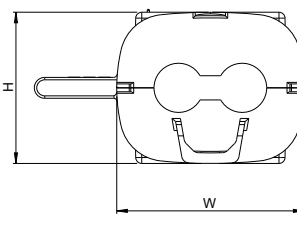
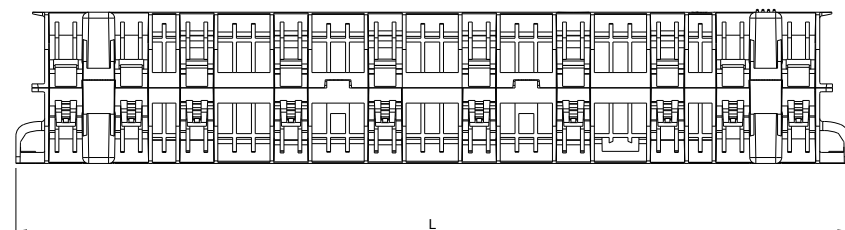

MJC-50/100PR-INL

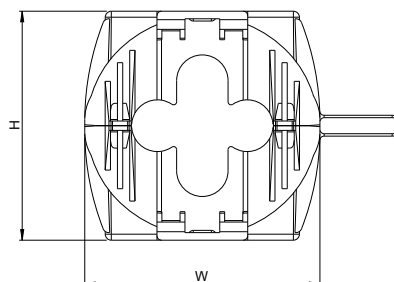
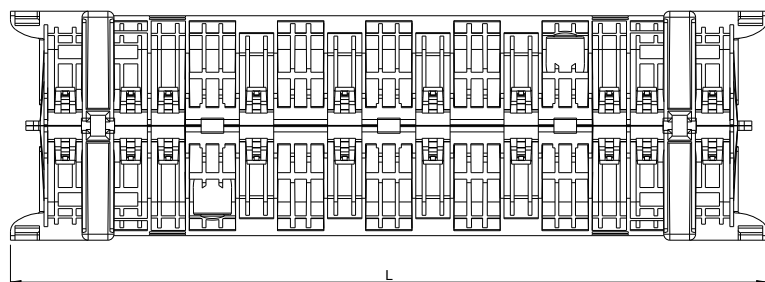

MJC-4/4BF-INL

MJC Blown Fiber Closure

Gel Closure for Blown Fiber Joint Applications

Accessories

Cable Plugs

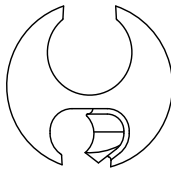
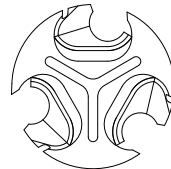
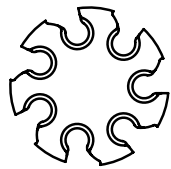
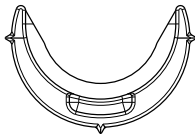
1 PE tube diameter +0.5 mm		Multiple PE tubes diameter +0.5 mm	Quantity per package	Ordering number	
15.3mm + dummy 8.6mm + dummy	2	14mm + 8.6mm 14mm + 8.6x14mm (flat) ²	10	MJC-PS-BF-W4/W1-2	
8.6mm + 2 dummys	3	8.6mm 8.6x14mm ^{2,3}	10	MJC-RU/GEL-BF-3W1-2	
2.5/6.0 tube only + 6 blind plugs	7	2.5/6.0 tube only ^{2,3}	10	MJC-RU/GEL-BF-7AA	
One cable only: 23.8mm	12	One cable only: 23.8mm	10	MJC-PR-BF-W12	

² For larger cable diameters, remove rubber pull-out before installation.

³ More configurations can be achieved with blind plugs and a various combinations of the above cable sizes.

Additional Accessories

Description	Quantity per package	Ordering number
Gel-sealing kit: Allows re-entry to closure	5	MJC-PS-GEL
Blind plug (not included in cable plug kits)	10	MJC-BP-UK01

COMMScope®

www.commscope.com

Visit our website or contact your local CommScope representative for more information.

© 2015 CommScope, Inc. All rights reserved.

All trademarks identified by ® or ™ are registered trademarks or trademarks, respectively, of CommScope, Inc.

This document is for planning purposes only and is not intended to modify or supplement any specifications or warranties relating to CommScope products or services.

PS-320209.1-AE (12/15)