

FGSB-MEXP-E-A/B/F

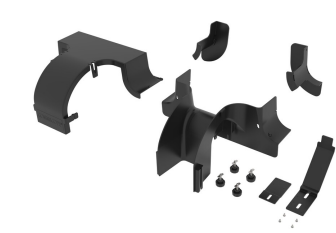

FiberGuide® 4-Inch Express Exit™, 4x4, 4x6, 4x12, 4x24in, Black

Product Classification

| | |
|-----------------------|---|
| Regional Availability | Asia Australia/New Zealand EMEA Latin America North America |
| Portfolio | CommScope® |
| Product Type | Express exit |
| Product Brand | FiberGuide® |
| Product Series | FGS |

General Specifications

| | |
|--------------|--------------|
| Color | Black |
| Orientation | Horizontal |
| Section Type | Express exit |

Dimensions

| | |
|-------------------|---|
| Height | 189.992 mm 7.48 in |
| Width | 315.976 mm 12.44 in |
| Length | 406.4 mm 16 in |
| System Dimensions | 102 mm x 102 mm (4 in x 4 in) 102 mm x 152 mm (4 in x 6 in) 102 mm x 305 mm (4 in x 12 in) 102 mm x 610 mm (4 in x 24 in) |

Ordering Tree

FGSB-MEXP-E-A/B/F

9

FGS

B

-

MEXP

-

10

A/B/F

Section Color

| | | |
|---|-------|--------|
| 9 | empty | yellow |
| | B | black |

Section Size

| | | |
|----|-----------|--|
| 10 | A/B/F | 4 x 4/6/12 in, with 2 x 2 in exit |
| | E-A/B/F | 4 x 4/6/12 in, with 4 x 4 in exit |
| | F-F/H-NC | 4 x 12/18/24 in, with 4 x 12 in exit, no cover |
| | G-A/B/F | 4 x 4/6/12 in, with 4 x 6 in exit |
| | LP-A/B/F | 4 x 4/6/12 in, with 2 x 2 in exit, low profile |
| | LP-CA | 4 x 4/6/12 in, with 2 x 4 in exit, low profile |
| | LP-G | 2 x 6 in, with 2 x 2 in exit, low profile |
| | GS-ABF-NC | 4 x 4/6/12 in, with 4 x 6 in exit, no cover |
| | CV | cover |
| NC | no cover | |

Material Specifications

Material Type Engineering Thermoplastic

Environmental Specifications

Flammability Rating CSA S143 | UL 2024 | UL 94 V-0

Halogen Characteristics Blue Angel | TCO '99 | WEEE

Safety Standard CSA | UL

Packaging and Weights

Included Hardware

Packaging quantity 1

Weight, net 2.075 kg | 4.575 lb

Regulatory Compliance/Certifications

| Agency | Classification |
|------------|---|
| CHINA-ROHS | Below maximum concentration value |
| REACH-SVHC | Compliant as per SVHC revision on www.commscope.com/ProductCompliance |
| ROHS | Compliant |
| UK-ROHS | Compliant |

