

THIS DRAWING IS UNPUBLISHED. RELEASED FOR PUBLICATION

© 2016 COMMSCOPE, INC. CONFIDENTIAL NOTICE: THESE DRAWINGS AND SPECIFICATIONS ARE THE PROPRIETARY PROPERTY OF COMMSCOPE, INC. AND MAY BE USED ONLY FOR THE SPECIFIC PURPOSE AUTHORIZED IN WRITING BY COMMSCOPE, INC.

OPTIMIZED FOR F/UTP CABLES	1711343-2
OPTIMIZED FOR S/FTP and F/FTP CABLES	1711343-1
NOTE	PN-DASH

OPTIONS AFTER PRODUCT APPLICATION:

RIGHT CABLE APPLICATION:

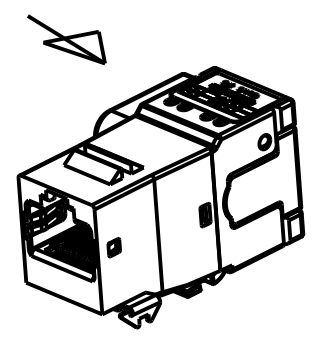

LEFT CABLE APPLICATION:

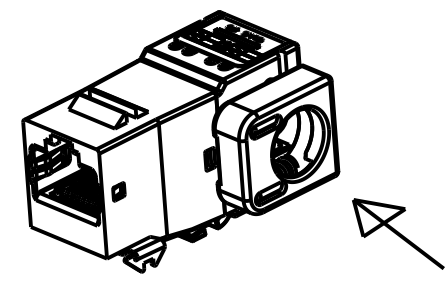

GENERAL VIEW:
BEFORE TERMINATION

6

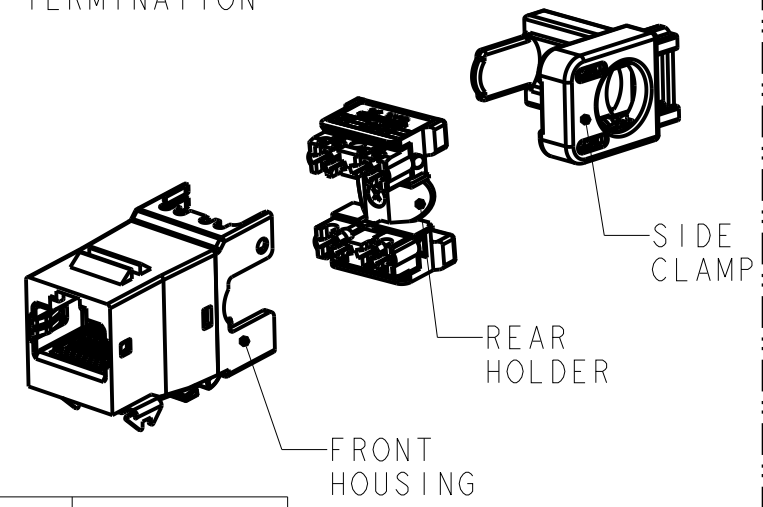

AS SHOWN	1711343-1
COMMENTS	PN

REVISIONS					
P	LTR	DESCRIPTION	DATE	DWN	APVD
	A	FIRST ISSUE	08NOV2006	ACG	JS
	B	ECR-08-006695	13MAR2008	ACG	JS
	BI	ADDED DASH 2	14NOV2008	ACG	JS
	C	REV PER BNS_CD_BRAND	02FEB2017	GG	DC

- 1 MATERIAL:
- FRONT AND REAR HOUSING, CABLE CLAMP: ZAMAK 5. (Z410).
 - IDC CONNECT BLOCK, DUST COVER AND LACING FIXTURE: POLYCARBONATE NATURAL.
 - CUTTING BLADE, SPRINGS, LATCH AND SHIELD CONTACT POINT: STAINLESS STEEL.
 - JACK CONTACTS: BERYLLIUM COPPER, PLATED WITH 1.27 μ m MINIMUM THICK GOLD IN LOCALIZED AREA AND 3.81 μ m MINIMUM THICK MATTE TIN IN SOLDER AREA OVER 1.27 μ m MINIMUM THICK NICKEL UNDERPLATE.
 - IDC TERMINALS: PHOSPHOROUS BRONZE, PLATED WITH 3.81 μ m MINIMUM THICK BRIGHT MATTE TIN OVER 1.27 MINIMUM THICK NICKEL UNDERPLATE.

2. AMP-TWIST-6S SL JACK WILL TERMINATE:

- SOLID CONDUCTORS: 22-24 AWG.
- STRANDED CONDUCTORS: 24-26 AWG.
- MAX. INSULATION DIAMETER: ϕ 1.60 mm.
- MAX. CABLE JACKET: ϕ 9.00 mm.

- 3 CAVITY ACCORDING TO IEC 60603-7-5 Ed. 1.0
4. MOUNTING PANEL THICKNESS 1.47-1.60 mm. (SEE SUGGESTED CUTOUT).

5 THESE TWO SUGGESTED CUTOUT OPENINGS ARE USED IN TANDEM WITH DUAL FRONT AND BACK CUTOUTS.

6 PACKAGING: ACCORDING TO SPEC. 107-93003. ONE SUB-ASSY FRONT HOUSING + ONE SUB-ASSY REAR HOLDER + ONE SUB-ASSY SIDE CLAMP AND ONE 1-SHEET PER POLYBAG.

7. REFER TO 411-93014 FOR TERMINATION INSTRUCTIONS USING SL SERIES TOOL TERMINATION: SL SERIES TOOL PN 1901551-1.

8. DIMENSIONS SHOWN ARE FOR REFERENCE ONLY.

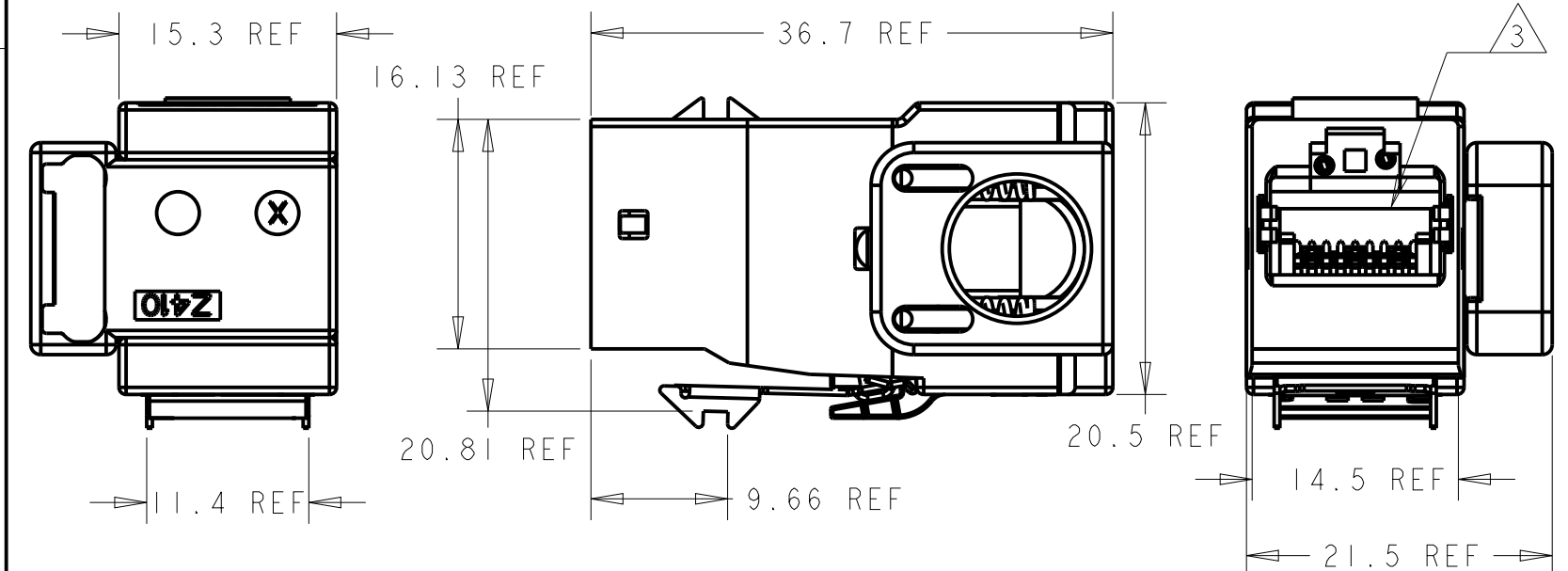

SUGGESTED CUTOUT: SINGLE AND FLUSH-MOUNT APPLICATION

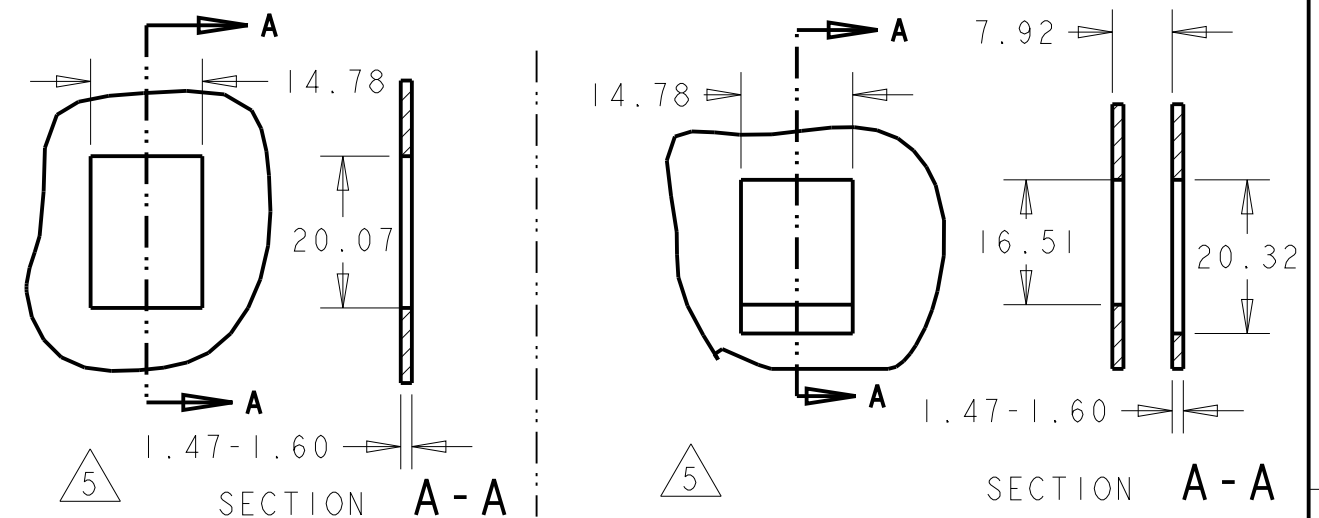

ELECTRICAL SCHEMATIC: WIRING T568 A/B

T568A			T568B		
WHITE/BLUE	5	5	WHITE/BLUE	5	5
BLUE	4	4	BLUE	4	4
WHITE/ORANGE	3	1	WHITE/ORANGE	1	1
ORANGE	6	2	ORANGE	2	2
WHITE/GREEN	1	3	WHITE/GREEN	3	3
GREEN	2	6	GREEN	6	6
WHITE/BROWN	7	7	WHITE/BROWN	7	7
BROWN	8	8	BROWN	8	8

COLOUR CODE IDC TERMINAL MODULAR JACK

THIS DRAWING IS A CONTROLLED DOCUMENT.

DIMENSIONS: mm	TOLERANCES UNLESS OTHERWISE SPECIFIED:	DWN 08NOV2006 A. CARRERAS	<p>COMMSCOPE, INC.</p> <p>AMP-TWIST-6S SL JACK SIDE EXIT W/O DUST COVER</p>
	0 PLC \pm	CHK 09NOV2006 J. SANABRA	
	1 PLC \pm	APVD 09NOV2006 J. SANABRA	
	2 PLC \pm	PRODUCT SPEC 108-93003	
MATERIAL -	FINISH -	APPLICATION SPEC 411-93014	NAME
		WEIGHT -	SIZE A3
		CUSTOMER DRAWING	CAGE CODE
			DRAWING NO C-1711343
			RESTRICTED TO
			SCALE
			SHEET OF
			REV C