

Qwik II SC/LC/ST CONNECTOR Installation & Assembly Instructions

1.0 GENERAL

1.01 These installation instructions describe the assembly procedure for the Qwik II SC, LC, and ST connectors, which allow termination on 900um fiber and 250um fiber with a fanout/breakout kit. This product can be re-terminated up to three times.

NOTE DO NOT use these instructions to install previous versions of Qwik SC, LC and ST connectors.

WARNING Always wear eye protection when handling optical fibers. Dispose of cut or cleaved ends properly.

1.02 The Qwik II Connector Universal Tool Kit is required (see **Figure 1**):

- Fiber Stripper
- Fiber Preparation Fluid
- Lint-free cloth wipes
- Scissors
- Fiber Cleaver
- Installation Instructions
- Strip length template
- Marker Pen
- 0.25/0.9mm Cable Clamp
- Carrying Bag

2.0 COMPONENTS

2.01 Identify components of the connector kit. (See **Figure 2 thru 4**)

NOTE Keep the ferrule's dust cap on until ready to install the connector.



Universal Tool Kit

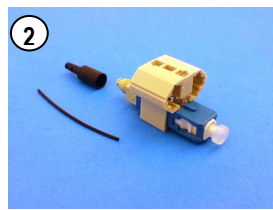

Qwik II SC Connector

To find out more about Commscope Solutions, visit us at: <http://www.commscope.com/>

For customer support regarding CommScope products, contact your local account representative or visit our website at <http://www.commscope.com/SupportCenter>

When using the Legacy Qwik Connector Tool Kit for terminating the Qwik II connectors, refer to instruction sheet 860 488 139 on the CommScope website.

ORDERING INFORMATION

Qwik II LC

Fiber Type	Housing Color	Cable Size	CommScope MID	CommScope Product Code
LO Multimode 50/125	Aqua	0.25mm,0.9mm	760117887	MFC-LCF-09-5X
Single-mode	Blue	0.25mm,0.9mm	760117895	SFC-LCF-09-8X
Multimode 62.5/125	Beige	0.25mm,0.9mm	760117903	MFC-LCF-09-6X
LO Multimode 50/125	Aqua	0.25mm,0.9mm	760117911	MFC-LCF-09-5X-25-PACK
Single-mode	Blue	0.25mm,0.9mm	760117929	SFC-LCF-09-8X-25-PACK
APC Single-mode	Green	0.25mm,0.9mm	760184697	SFC-LCF-09-8A-25-PACK
Multimode 62.5/125	Beige	0.25mm,0.9mm	760117937	MFC-LCF-09-6X-25-PACK

Qwik II SC

Fiber Type	Housing Color	Cable Size	CommScope MID	CommScope Product Code
LO Multimode 50/125	Aqua	0.25mm,0.9mm	760117945	MFC-SCF-09-5X
Single-mode	Blue	0.25mm,0.9mm	760117952	SFC-SCF-09-8X
Multimode 62.5/125	Beige	0.25mm,0.9mm	760117960	MFC-SCF-09-6X
LO Multimode 50/125	Aqua	0.25mm,0.9mm	760117978	MFC-SCF-09-5X-25-PACK
Single-mode	Blue	0.25mm,0.9mm	760117986	SFC-SCF-09-8X-25-PACK
APC Single-mode	Green	0.25mm,0.9mm	760184689	SFC-SCF-09-8A-25-PACK
Multimode 62.5/125	Beige	0.25mm,0.9mm	760117994	MFC-SCF-09-6X-25-PACK

Qwik II ST

Fiber Type	Housing Color	Cable Size	CommScope MID	CommScope Product Code
LO Multimode 50/125	Aqua	0.25mm,0.9mm	760118000	MFC-STF-09-5X
Single-mode	Blue	0.25mm,0.9mm	760118018	SFC-STF-09-8X
Multimode 62.5/125	Beige	0.25mm,0.9mm	760118026	MFC-STF-09-6X
LO Multimode 50/125	Aqua	0.25mm,0.9mm	760118034	MFC-STF-09-5X-25-PACK
Single-mode	Blue	0.25mm,0.9mm	760118042	SFC-STF-09-8X-25-PACK
Multimode 62.5/125	Beige	0.25mm,0.9mm	760118059	MFC-STF-09-6X-25-PACK

Consumables and Tools

Description	CommScope MID	CommScope Product Code
Qwik II Connector Universal Tool Kit	760119131	QK-TERM-TOOL-KIT-QWIK II

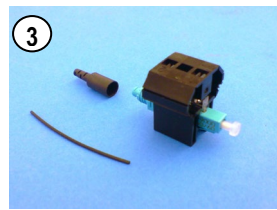

Qwik II LC Connector

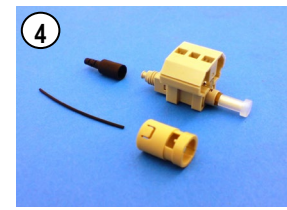

Qwik II ST Connector

3.0 FIBER TERMINATION

3.01 Tools required for installation are the Precision Cleaver and a fiber stripper.

NOTE When using a 900um Fanout/Breakout kit to upjacket 250um fiber, follow the manufacturer's instructions. After the kit is installed properly, the following procedures for Qwik II termination are applicable. The 0.25/0.9mm cable clamp is required.

3.02 When using a 900um Fanout/Breakout Kit:

Measure 10 inches from end of 900um tube and place the 0.25/0.9mm tube into the 900um cable clamp. Slide the cable clamp to tighten tube down. (See **Figure 5**)

3.03 Slide the 900um boot onto the fiber. (See **Figure 6**)

3.04 Reference the Strip length template; strip the fiber to a length of 40mm by removing 10mm at a time. (See **Figure 7**)

3.05 From the end of the 900um buffered fiber, place a mark at 15.5mm for SC and ST or a mark at 11.5mm for LC. (See **Figure 8**)

3.06 Clean the stripped fiber with an alcohol wipe to remove any debris. Check the fiber integrity by bending the stripped end slightly at 60°. (See **Figure 8**)

3.07 Set the stripped fiber onto the cleaver such that the 900um buffered fiber's edge is between 10.5mm to 11mm position and cleave. (See **Figure 9**)

3.08 The wedge clip is engaged at shipment. If it has become dislodged, squeeze the top and bottom of the wedge clip, insuring it is inserted in the connector body. A click will be heard. (See **Figure 10**)

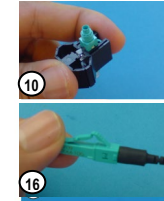
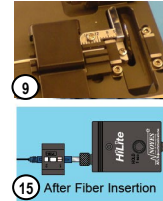
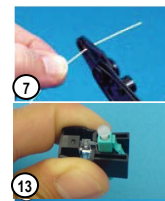
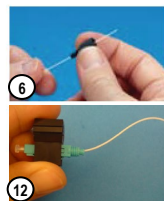
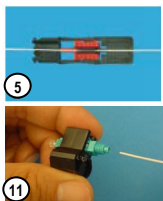

3.09 OPTION A:

1. Insert the cleaved fiber into the rear of the connector until a connection is made. Make a bend in the fiber to maintain connection. (See **Figure 11 and 12**)
2. Release the wedge lip by squeezing both sides until the wedge dislocates itself from the connector body. Remove the wedge clip. (See **Figure 13**)

OPTION B: Use a Visual Fault Identifier or VFI as an aid to determine if cleaved fiber and stubbed fiber are connected properly.

1. Remove the connector dust cap and insert the connector into the VFI. Turn the VFI on; there will be a red glow in Position 1 of the wedge clip. (See **Figure 14**)
2. Insert the cleaved fiber into the rear of the connector until the red glow dims in Position 1 of the wedge clip. Make a bend in the fiber to maintain connection. (See **Figure 15**)
3. Release the wedge lip by squeezing both sides until the wedge dislocates itself from the connector body. Remove the wedge clip. Remove the VFI from the connector and place the dust cap back onto the connector's ferrule.

3.10 Slide the boot up and over the rear of the connector body. Termination is complete. (See **Figure 16**)

3.11 When using a 900um Fanout/Breakout Kit: Remove the cable clamp from the 900um tubing.

3.12 ST CONNECTOR ONLY. Install the connector housing onto the connector. (See **Figure 17**)

