

ITEM	PART NO.	DESCRIPTION	QTY.	WEIGHT
1	MTC306501	Square Tube T-Arm Weldment	3	89.73 LBS
2	GB-0522A	5/8" X 2-1/4" GALV BOLT KIT (A325)	12	0.29 LBS
3	MTC306504	CW 1550 RM Weldment	3	43.62 LBS
4	MT38424	3/4" X 24" GALV THREADED ROD	6	2.99 LBS
5	MT38440	3/4" X 40" GALV THREADED ROD GRADE B7	6	4.98 LBS
6	GWL-06	3/4" GALV LOCK WASHER	12	0.09 LBS
7	GN-06	3/4" GALV HEX NUT	12	0.04 LBS
8	MTC305503	Pipe Mount Plate, 3-1/2" Pipe , 4" Sq Tube	6	9.35 LBS
9	MTC305505	Sq Galv U-Bolt, 1/2-13 x 4 x 6	12	0.88 LBS
10	GUB-4356	1/2" X 3-5/8" X 6" GALV U-BOLT	12	0.71 LBS
11	GWF-04	1/2" GALV FLAT WASHER	24	0.06 LBS
12	GWL-04	1/2" GALV LOCK WASHER	24	0.09 LBS
13	GN-04	1/2" GALV HEX NUT	24	0.04 LBS

REVISIONS				
REV.	ZONE	DESCRIPTION	BY	DATE
A		INITIAL RELEASE	MSM	11/21/11

NOT SHOWN

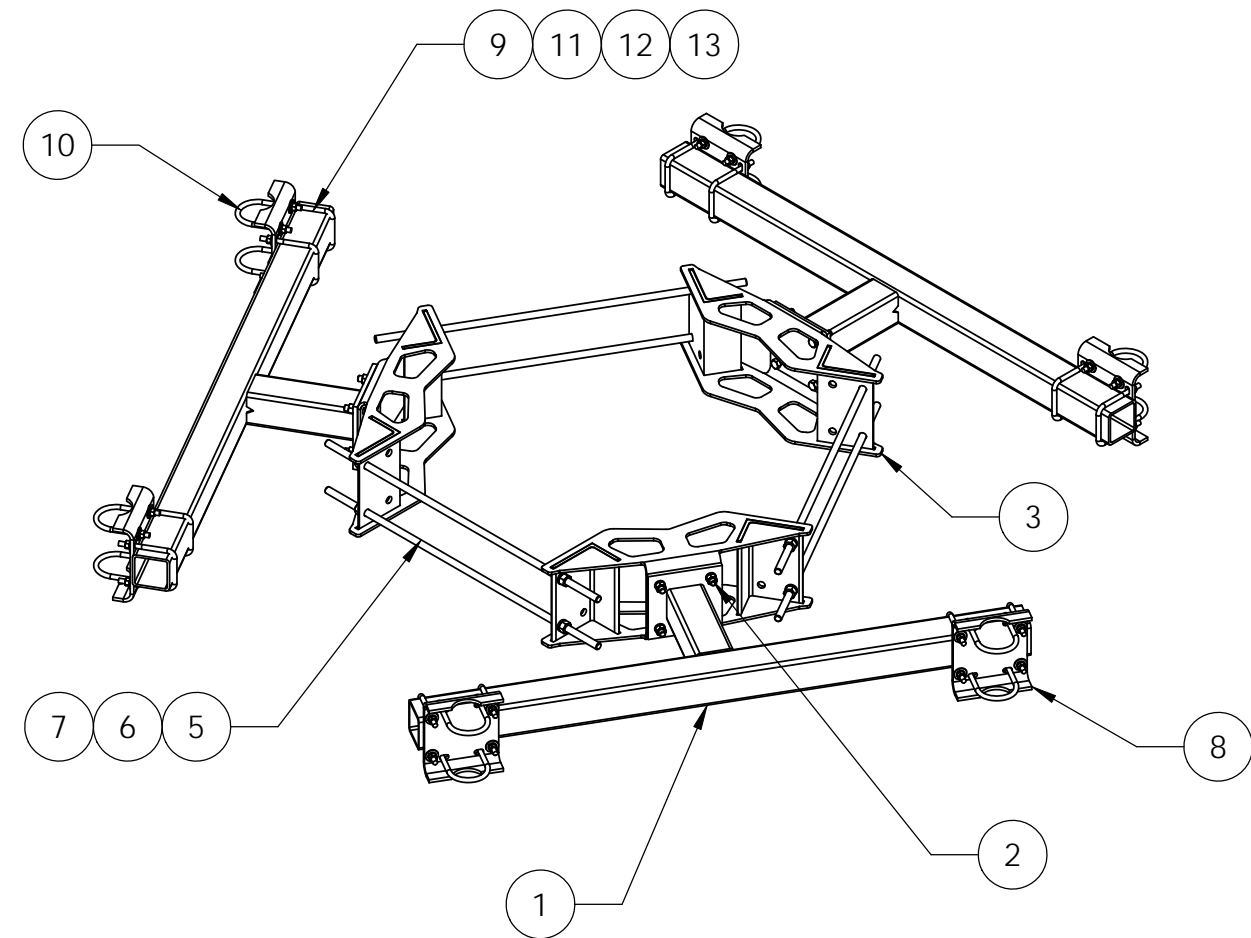
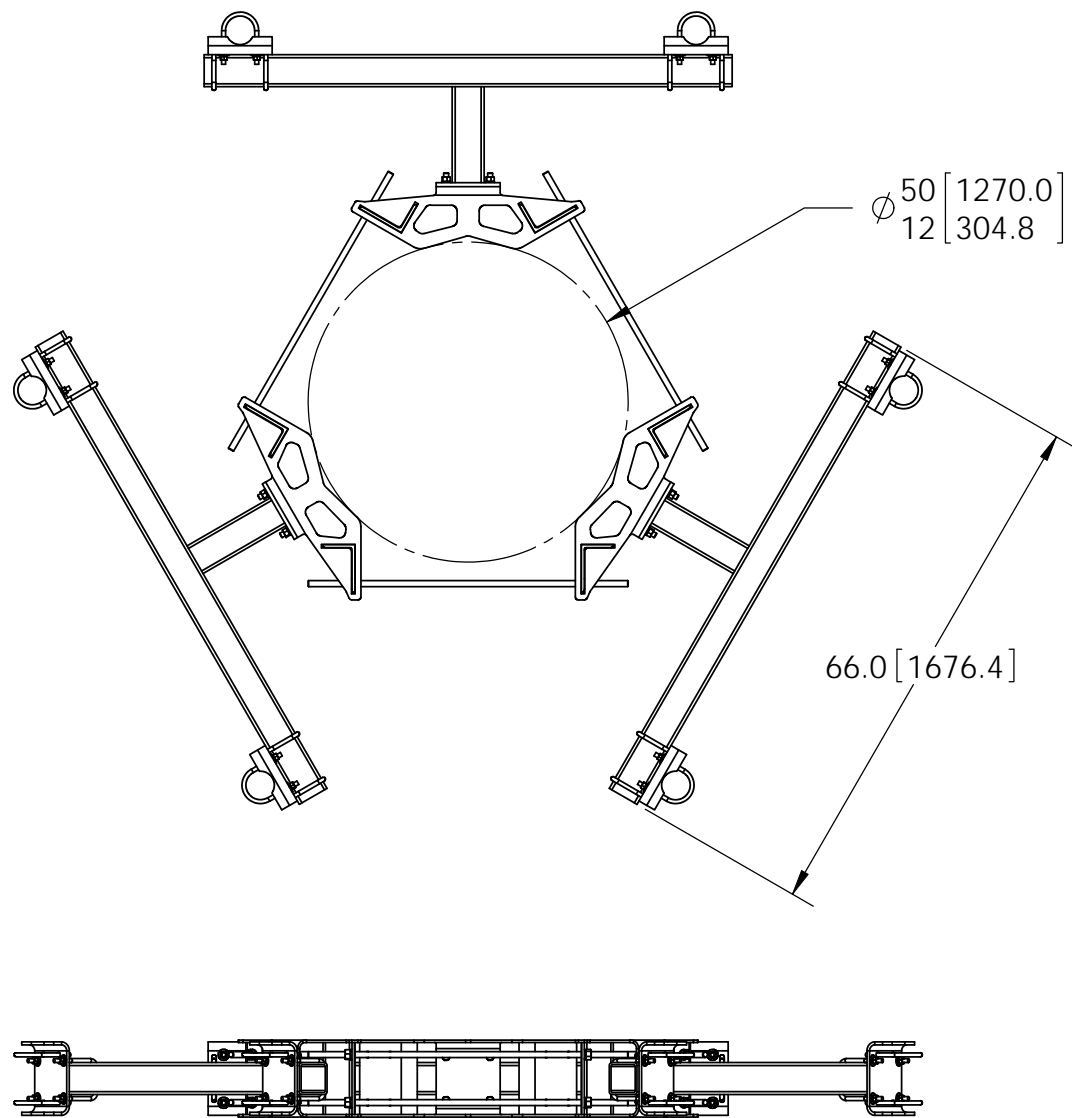

NOTES:  
1. ALL METRIC DIMENSIONS ARE IN BRACKETS.

These drawings and specifications are the proprietary property of CommScope Inc. and may be used only for the specific purpose authorized in writing by CommScope Inc.  ALL DIMENSIONS ARE IN INCHES U.O.S. TOLERANCES UNLESS OTHERWISE SPECIFIED: .X = ± .12      ANGLES ±2° .XX = ± .06      FRACTIONS ±1/32 .XXX = ± .03  REMOVE BURRS AND BREAK EDGES .005  DO NOT SCALE THIS PRINT	DRAWN BY: MSM	SHEET: 1 of 1	PART NUMBER: MC-HPM1250-B
	CHECKED BY: TP	SCALE: NTS	DESCRIPTION: 3 Sedctor Square Tube, 1550 RM, 6 Pipe Mounts
	DATE: 11/21/11	MATERIAL: A36, A53, A500	DRAWING TYPE: ASSEMBLY DRAWING
	REVISION: A	FINISH: GALV A123	WEIGHT: 535.60 LBS