

# MD-SSA6

---

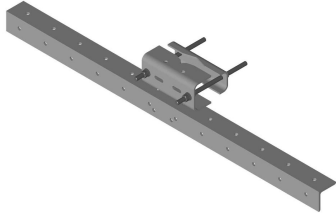

## Tower Leg Mounted Microwave Antenna Channel Support Kit, 72 in

### Product Classification

**Product Type** Microwave strut support

### General Specifications

**Mounting** Straight or tapered legs up to 203.2 mm (8 in) OD

**Pipe, quantity** 0

**Tower Taper** Non-tapered

### Dimensions

**Height** 152.4 mm | 6 in

**Width** 1,828.8 mm | 72 in

**Length** 203.2 mm | 8 in

**Mounting Diameter, maximum** 203.2 mm | 8 in

### Material Specifications

**Material Type** Hot dip galvanized steel

### Mechanical Specifications

**Wind Rating** For Specifications, please contact [steelproducts@commscope.com](mailto:steelproducts@commscope.com) or call 800-255-1479

### Packaging and Weights

**Included** Angle | Attachment hardware | Clamps

**Packaging quantity** 1

**Weight, net** 38.6 kg | 85.098 lb

### Regulatory Compliance/Certifications

# MD-SSA6

---

**Agency**

ISO 9001:2015

**Classification**

Designed, manufactured and/or distributed under this quality management system

\* Footnotes

**Wind Rating**

BWS—Base Wind Speed; FBC—Florida Building Code