

# MT-F1607

---

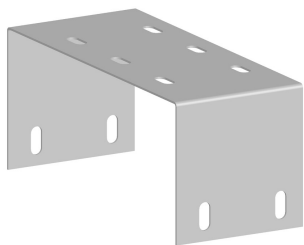

Splice for Wall Kit, for four coaxial cable runs

## Product Classification

**Product Type**                      Splice kit

## General Specifications

**Cable Runs, quantity**                      4

**Mounting**                                      Wall coaxial cable support kits

## Dimensions

**Height**                                      127 mm   |   5 in

**Width**                                        127 mm   |   5 in

**Length**                                      304.8 mm   |   12 in

# MT-F1607

## Outline Drawing

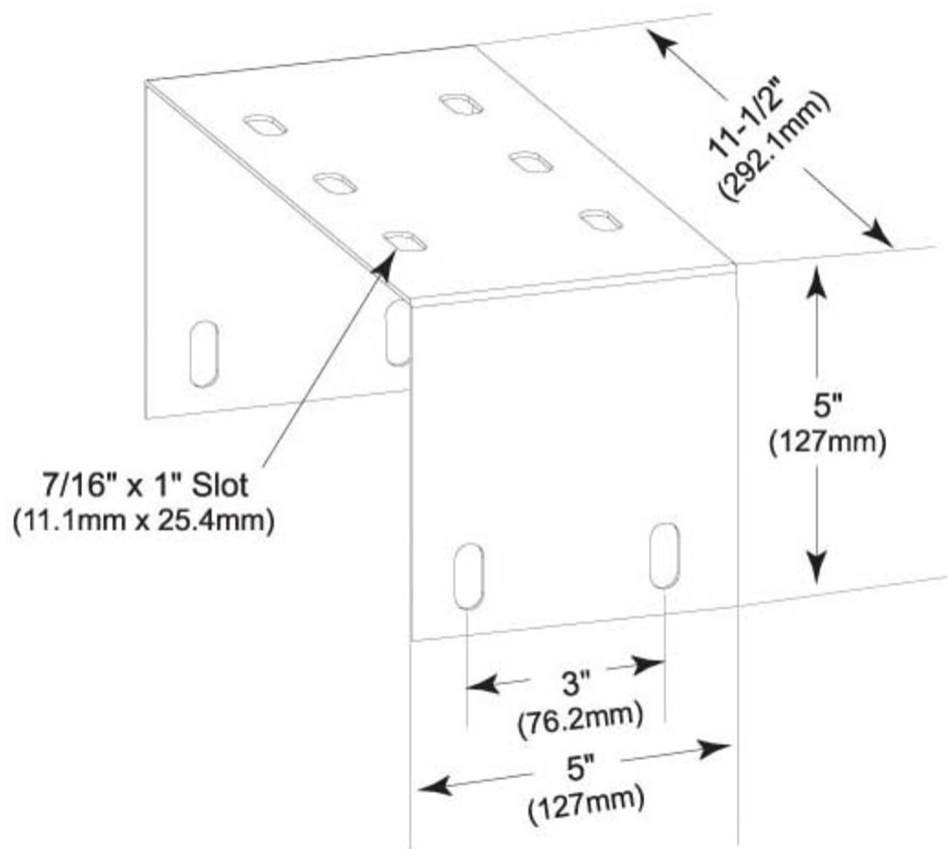

## Material Specifications

**Material Type** Galvanized steel

## Mechanical Specifications

**Wind Rating** For Specifications, please contact your local ANDREW representative

## Packaging and Weights

**Included** Hardware | Splices

**Packaging quantity** 1

**Weight, net** 1.1 kg | 2.425 lb

# MT-F1607

---

## Regulatory Compliance/Certifications

Agency	Classification
ISO 9001:2015	Designed, manufactured and/or distributed under this quality management system

## \* Footnotes

Wind Rating	BWS—Base Wind Speed; FBC—Florida Building Code
-------------	------------------------------------------------