

TA-BYFYF-12.6



1.5-3.5 Female to 1.5-3.5 Female Adapter

Product Classification

Product Type Adapter

General Specifications

Body Style Straight

Inner Contact Plating Gold

Interface 1.5-3.5 Female

Interface 2 1.5-3.5 Female

Mounting Angle Straight

Outer Contact Plating Silver

Dimensions

Length 12.6 mm | 0.496 in

Diameter 4.7 mm | 0.185 in

Outline Drawing

TA-BYFYF-12.6

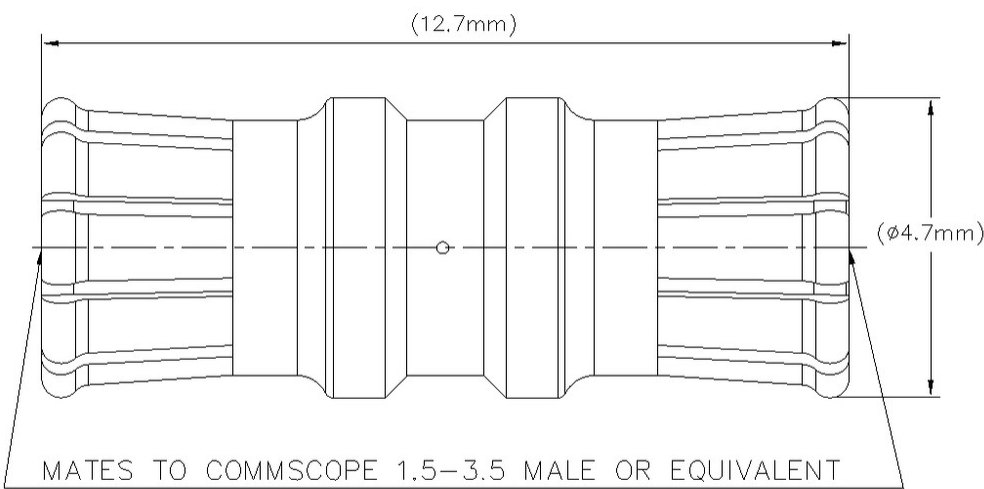

Electrical Specifications

| | |
|-----------------------------------|---|
| 3rd Order IMD at Frequency | -110 dBm @ 3500 MHz -116 dBm @ 1800 MHz |
| 3rd Order IMD Test Method | Two +43 dBm carriers |
| Connector Impedance | 50 ohm |
| dc Test Voltage | 1000 V |
| Inner Contact Resistance, maximum | 2 mOhm |
| Insulation Resistance, minimum | 5000 MOhm |
| Operating Frequency Band | 0 – 6000 MHz |
| Outer Contact Resistance, maximum | 2 mOhm |
| Peak Power, maximum | 100 kW |

VSWR/Return Loss

| Frequency Band | VSWR | Return Loss (dB) |
|----------------|-------|------------------|
| 450–2200 MHz | 1.065 | 30.04 |
| 2200–3800 MHz | 1.065 | 30.04 |
| 3800–4200 MHz | 1.083 | 27.99 |
| 4200–6000 MHz | 1.222 | 20.01 |

TA-BYFYF-12.6

Mechanical Specifications

| | |
|----------------------------------|------------------|
| Axial Range | 12.6 14.6 |
| Insertion Force | 15 N 3.372 lbf |
| Separation Force | 15 N 3.372 lbf |
| Interface Durability | 100 cycles |
| Axial Misalignment | 1 mm 0.039 in |
| Radial Float/Misalignment | 4 ° |

Environmental Specifications

| | |
|---|---------------------------------------|
| Operating Temperature | -55 °C to +85 °C (-67 °F to +185 °F) |
| Storage Temperature | -65 °C to +125 °C (-85 °F to +257 °F) |
| Attenuation, Ambient Temperature | 20 °C 68 °F |
| Average Power, Ambient Temperature | 40 °C 104 °F |
| Climatic Sequence Test Method | IEC 60068-1 |
| Corrosion Test Method | IEC 60068-2-11 |
| Damp Heat Steady State Test Method | IEC 60068-2-3 |
| Thermal Shock Test Method | IEC 60068-2-14 |
| Vibration Test Method | IEC 60068-2-6 |

Packaging and Weights

| | |
|--------------------|-------------------|
| Weight, net | 0.57 g 0.001 lb |
|--------------------|-------------------|

Regulatory Compliance/Certifications

| Agency | Classification |
|---------------|--|
| CHINA-ROHS | Below maximum concentration value |
| REACH-SVHC | Compliant as per SVHC revision on www.andrew.com/ProductCompliance |
| ROHS | Compliant |
| UK-ROHS | Compliant |

