

4

3

2

1

1.0 GENERAL NOTES

- 1.1 ALL METRIC DIMENSIONS ARE IN BRACKETS [X.X]
- 1.2 FEATURES CRITICAL TO QUALITY ARE INDICATED IN ROUNDED BOX (X.X)
- 1.3 3D DIGITAL FILES ARE FOR REFERENCE. IN CASE OF CONFLICT FOLLOW PDF DRAWING.
- 2.0 DESIGN NOTES
- 3.0 MANUFACTURING/SPECIAL REQUIREMENTS
 - 3.1 BREAK SHARP EDGES AND DEBURR PART FOR SAFE HANDLING
 - 3.2 GALVANIZE PER ASTM A123
 - 3.3 MARK WITH PART NUMBER, REVISION, AND VENDOR ID WITH ETCH, STAMP OR LABEL. CHARACTERS TO BE 0.12" TO 0.24" HIGH AND LEGIBLE TO THE UNAIDED EYE.
- 4.0 TEST
- 5.0 PACKAGING
 - 5.1 PACKAGING SHALL MEET COMMSCOPE REQUIREMENTS PER DOCUMENT IS-PL-3005

REVISIONS			
REV.	DESCRIPTION	DATE	APPROVED
A	INITIAL RELEASE	LS1146 25SEP23	BCROSS 40179845CMO

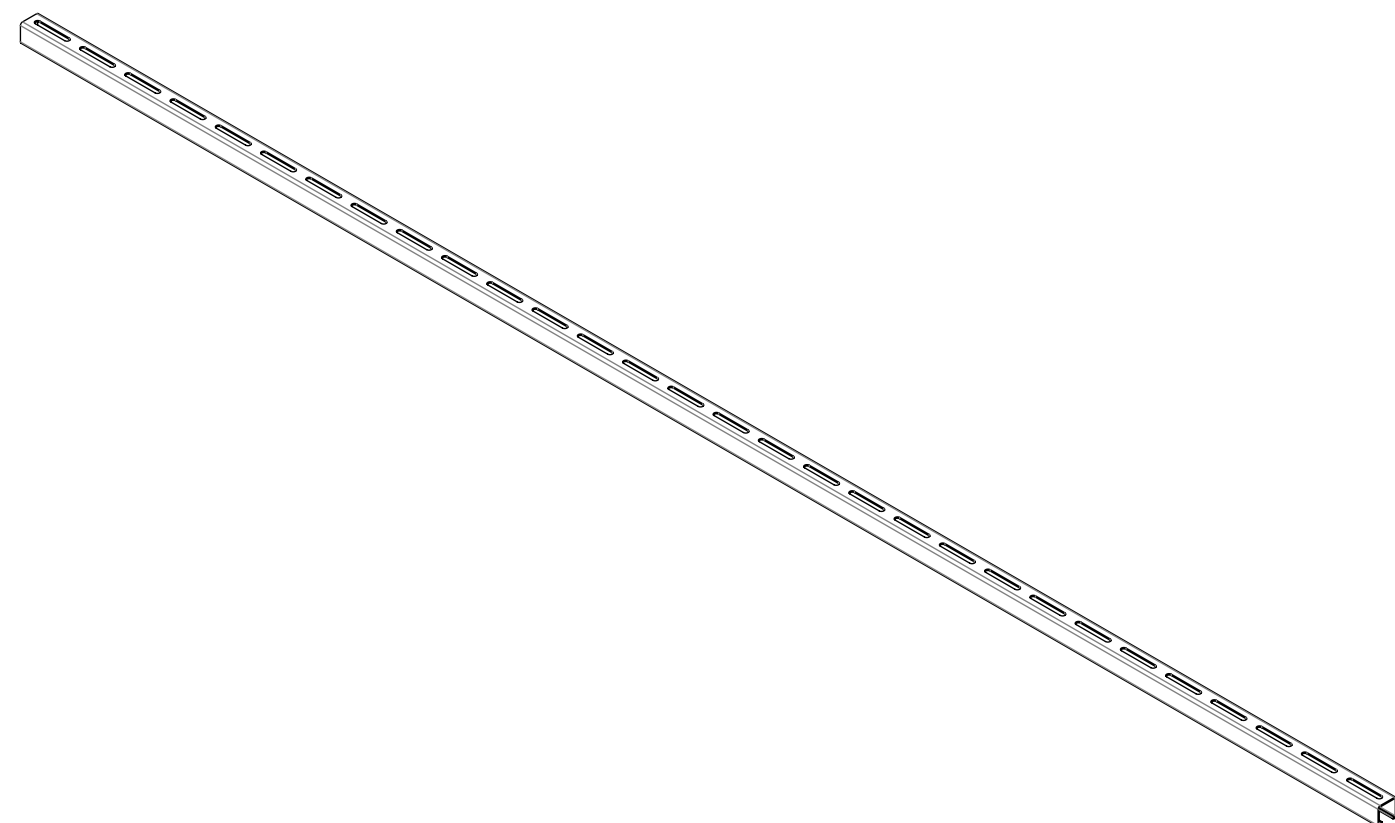
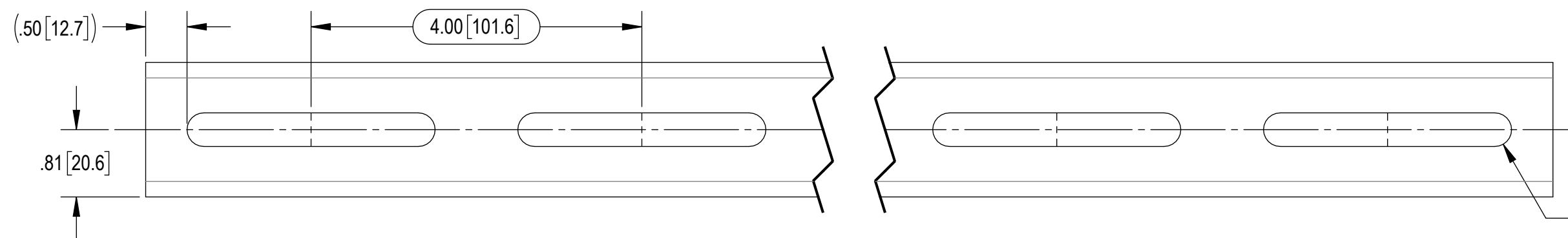
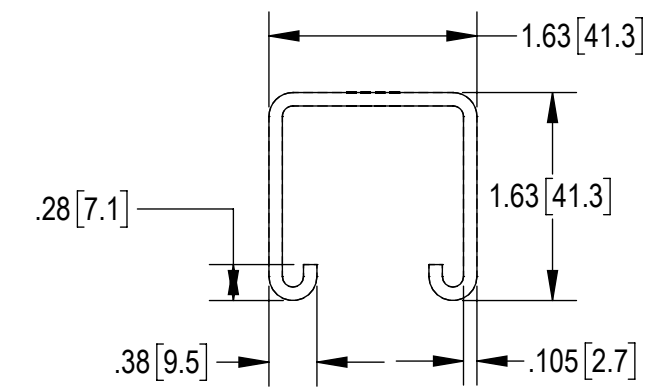
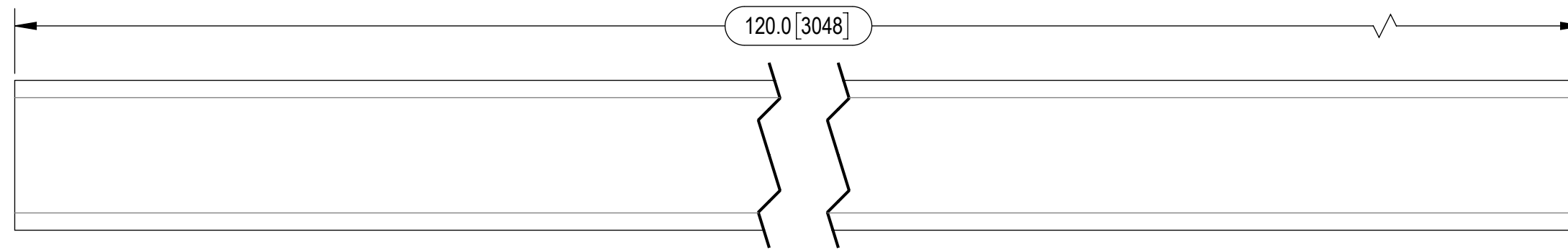

COMMSCOPE, INC. OF NORTH CAROLINA									
TOLERANCES					SAP MATERIAL MASTER				
1 PLACE .X[X] ± 0.06[1.5]		3 PLACE .XXX[X] ± 0.010[[0.3]			UNI-158-10-001				
2 PLACE .XX[X] ± 0.03[0.8]		ANGLES ± 2°							
FINISH PREGALVANIZED					MATERIAL STEEL, 12 GA				
UNLESS OTHERWISE SPECIFIED DIMENSIONS ARE IN INCHES INTERPRET PER ANSI Y 14.5M-1994	CE	LS1146	25SEP23	UNISTRUT, 1-5/8", 10'-LONG, 3"-SLOTS					
	RW	LS1146	09/26/2023						
	AD	BCROSS	09/26/2023						
	RE	LS1146	09/28/2023						
	ECN	40179845CMO							
SCALE 1:1.5		DOCUMENT NO. UNI-158-10-001							
SIZE	Auth Group	INSL	MODEL			DRAWING			SHEET
C			VERSION	STATUS	REVISION	VERSION	STATUS	REVISION	1 OF 1
			00	IW	A	00	RE	A	

DENSITY	0.28	lbs/in ³
MASS	17.60	lbs
VOLUME	61.91	in ³
SURFACE AREA	1225.94	in ²
HEIGHT	1.6"	
LENGTH	120"	
WIDTH	1.63"	

4

3

2

1