

# TES-SS-MSK3 | PIPE TO PIPE CLAMP

---

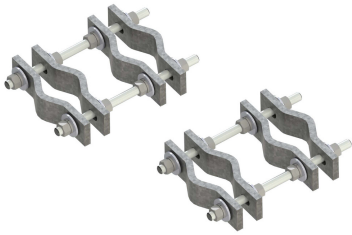

Pipe to Pipe Clamps for 1.66" to 4.5" Pipes

## Product Classification

**Product Type** Clamp set

## General Specifications

**Mounting** Pipe-to-pipe

## Dimensions

**Pipe Length** 304.8 mm | 12 in

**Mounting Diameter, maximum** 114.3 mm | 4.5 in

**Mounting Diameter, minimum** 38.1 mm | 1.5 in

**Pipe Outer Diameter** 15.875 mm | 0.625 in

## Material Specifications

**Material Type** Hot dip galvanized steel

## Packaging and Weights

**Included** Clamp halves | Threaded rod

**Packaging quantity** 2