

TES-SS-MSK9
UNIVERSAL LEG CLAMP

FIT UP TO 3 1/2" O.D PIPE
FIT UP TO 3" 60 DEG ANGLES
FIT UP TO 2 1/2" 90 DEG ANGLES

3 4 5 6
(TYP)

7

NOTES:
1. HOT-DIPPED GALVANIZED PER ASTM A123.

TES-SS-MSK9 (UNIVERSAL LEG CLAMP)						
ITEM NO.	QTY.	PART NO.	DESCRIPTION	SHEET #	WT	
1	1	BP51875-625	PL 3/16" X 5 3/16" X 6 1/4" A36 BENT PLATE	MSK9-F1	2	
2	1	BP56875-625	PL 3/16" X 5 11/16" X 6 1/4" A36 BENT PLATE	MSK9-F2	2	
3	2	---	THREADED ROD 5/8" DIA. X 10" Fy = 36KSI HDG	---	--	
4	4	FW-625	5/8" HDG USS FLAT WASHER	---	0	
5	4	LW-625	5/8" HDG LOCK WASHER	---	0	
6	4	NUT-625	5/8" HDG HEX NUT	---	2	
7	1	TES-SS-CG-SM	WIRE ROPE GUIDE - STUD MOUNT	---	1	
					GALVANIZED WT	7

DRAWN BY: PF CHECKED BY: KW/SK

REV. DESCRIPTION BY DATE
 △ FIRST ISSUE PF 07/18/23

△
 △
 △
 △

SHEET TITLE:

TES-SS-MSK9
UNIVERSAL LEG CLAMP

SHEET NUMBER: REV #:

TES-SS-MSK9 0

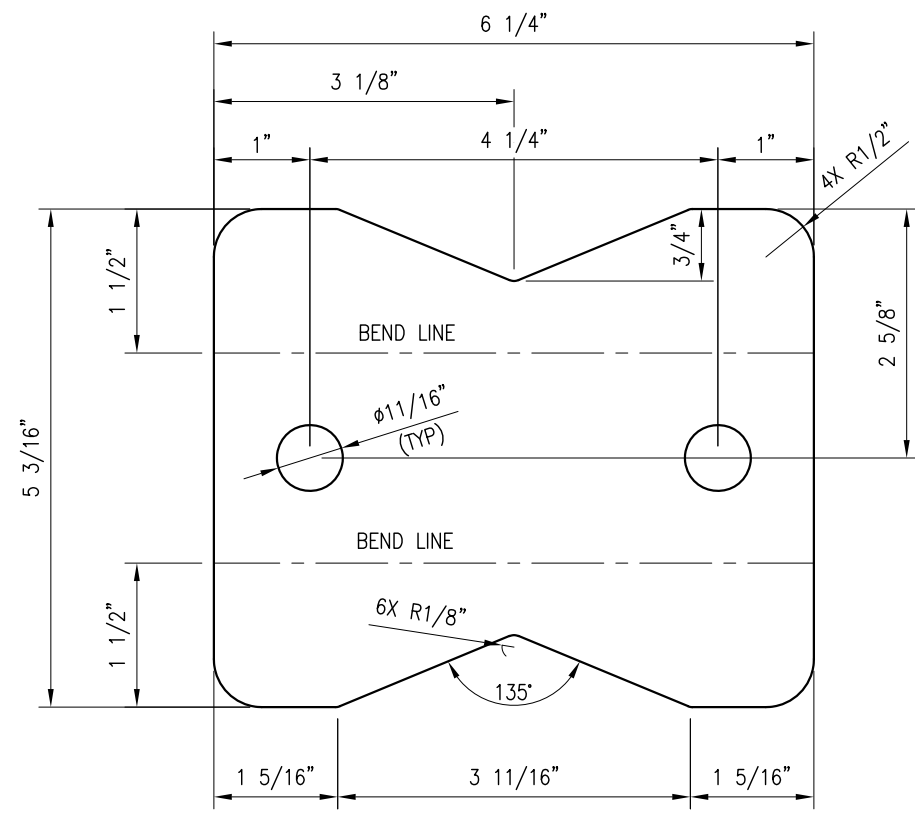

BEFORE BENDING

BP51875-625
 PL 3/16" X 5 3/16" X 6 1/4" A36 BENT PLATE
 (1.83 LBS)

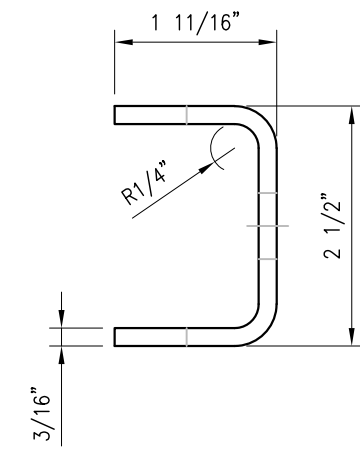

AFTER BENDING

NOTES:
 1. HOT-DIPPED GALVANIZED PER ASTM A123.

DRAWN BY: PF CHECKED BY: KW/SK

REV.	DESCRIPTION	BY	DATE
1	FIRST ISSUE	PF	07/18/23

SHEET TITLE:

FABRICATION DETAILS

SHEET NUMBER: REV #:

MSK9-F1 0

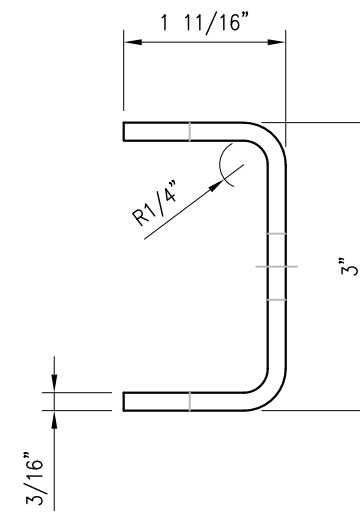
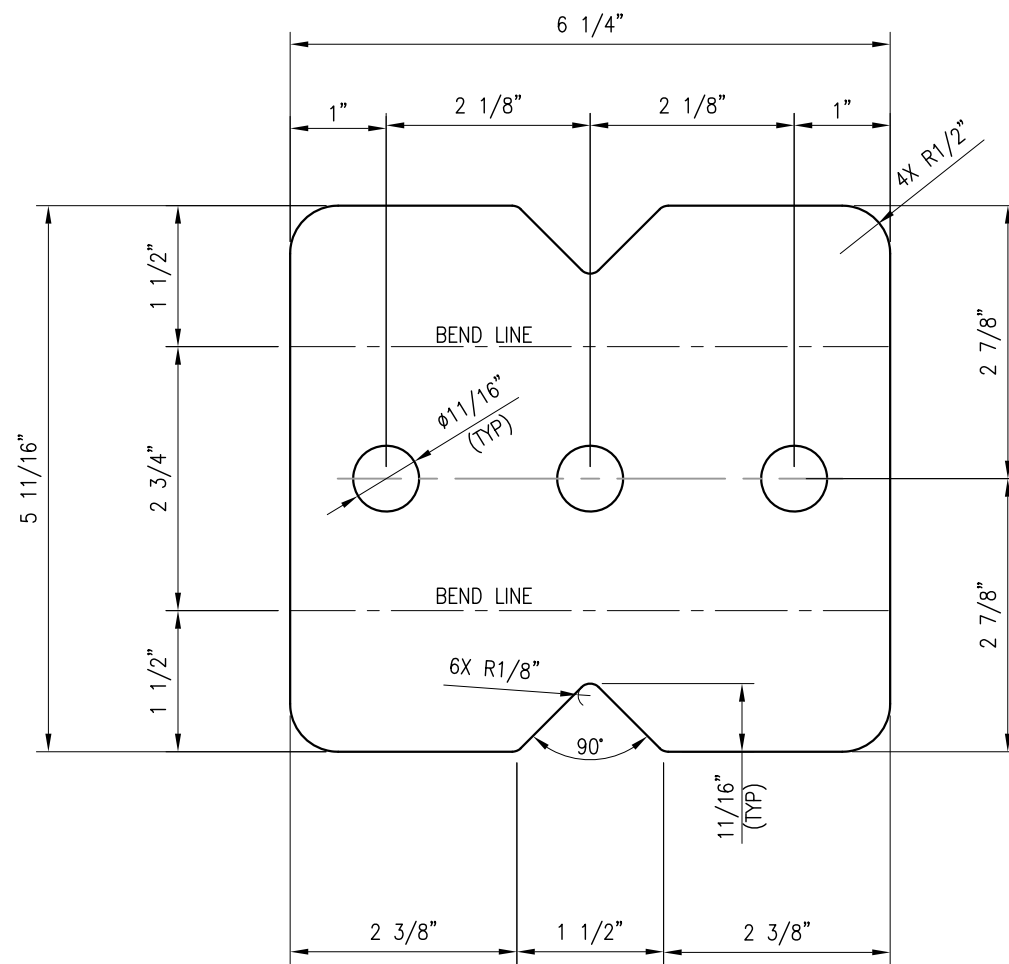

AFTER BENDING

BEFORE BENDING

BP56875-625
 PL 3/16" X 5 11/16" X 6 1/4" A36 BENT PLATE
 (1.94 LBS)

NOTES:
 1. HOT-DIPPED GALVANIZED PER ASTM A123.

DRAWN BY: PF CHECKED BY: KW/SK

REV.	DESCRIPTION	BY	DATE
1	FIRST ISSUE	PF	07/18/23

SHEET TITLE:

FABRICATION DETAILS

SHEET NUMBER: REV #:

MSK9-F2 0