



Bracket for Armor Fittings (BAF) Installation Instructions

General

The **CommScope®** brackets for armor fittings (BAF) provide greatly improved fiber cable restraint and routing along equipment rack rails and ultimately, into termination/splicing shelves. These kits are designed for use with armored trunk cables with NPT fittings, either installed from the factory or added in the field. Cables are grounded to the equipment rack through the brackets, using the standard mounting hardware provided with the kits.

Ordering information for the kits is provided below:

Material ID	Description
760122895	BAF-1/2-NPT kit – for use with 1/2-inch armor fittings
760122903	BAF-3/4-NPT kit – for use with 3/4-inch armor fittings
760122911	BAF-1-NPT kit – for use with 1-inch armor fittings
760122929	BAF-1-1/4-NPT kit – for use with 1-1/4-inch armor fittings
760122937	BAF-1-1/2-NPT kit – for use with 1-1/2-inch armor fittings

Tools Required

- Flat head screwdriver
- 5/16" hex socket with extension and ratchet or 5/16" open-end wrench
- Pliers

Cautions

When installing and using this product, basic safety precautions should always be followed to reduce the risk of fire, electric shock, and injury to persons, including the following:

- Disconnected optical components may emit invisible optical radiation that can damage your eyes. Never look directly into an optical component that may have a laser coupled to it. Serious and permanent retinal damage is possible. If accidental exposure to laser radiation is suspected, consult a physician for an eye examination.
- Wearing safety glasses during installation of this product is recommended. Although standard safety glasses provide no protection from potential optical radiation, they offer protection from accidental airborne hardware and cleaning solvents.

Parts List

Verify parts against the parts list below:

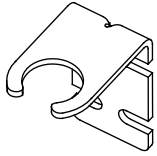

BAF-1/2-NPT

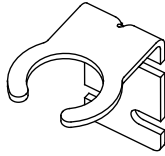

BAF-3/4-NPT

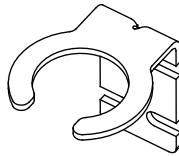

BAF-1-NPT

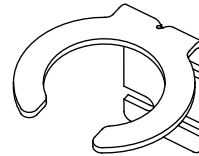

BAF-1-1/4-NPT

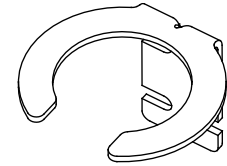

BAF-1-1/2-NPT

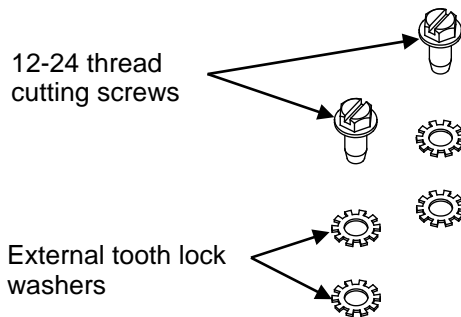

Each kit consists of one bracket, two mounting screws and four lock washers.

Step 1 – Mount Bracket to Equipment Rack

1. Select a convenient location on the equipment rack to attach the bracket for most advantageous cable routing. Mount the bracket using the supplied hardware as shown on next page.

Note: Both external tooth lock washers must be used in the positions shown above to ensure a ground connection through the mounting hardware. Use a multi-meter or suitable device to verify proper grounding of bracket to equipment rail before proceeding. **Equipment rack must be grounded.**

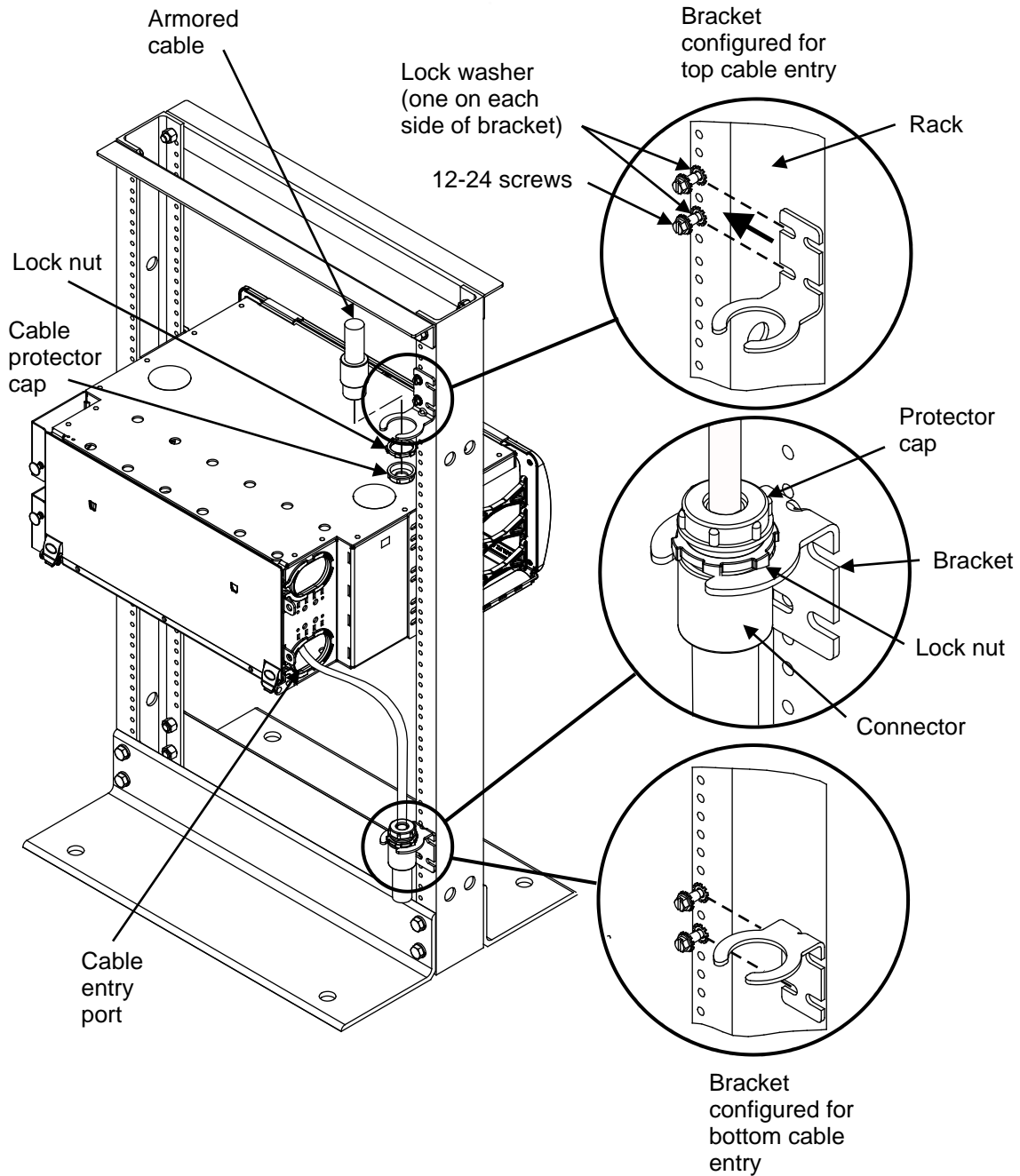

Step 2 – Install Armored Cables

1. Remove lock nuts and slide connector on end of armored cable into slot in bracket.
2. After sliding into slot, hand tighten locknut. Grasp connector body and use pliers to turn the locknut the final 1/4- to 1/2-turn required to fully secure it in place. Insure that the cable protector cap is in place.

Step 3 – Routing Fibers into a shelf

1. Carefully route buffer tubes from cables through port(s) provided in shelf.

Trademarks

All trademarks identified by ® or ™ are registered trademarks or trademarks, respectively, of CommScope, Inc. This document is for planning purposes only and is not intended to modify or supplement any specifications or warranties relating to CommScope products or services. CommScope is committed to the highest standards of business integrity and environmental sustainability, with a number of CommScope's facilities across the globe certified in accordance with international standards, including ISO 9001, TL 9000, and ISO 14001. Further information regarding CommScope's commitment can be found at: www.commscope.com/About-Us/Corporate-Responsibility-and-Sustainability

How to Contact Us

Visit our website or contact your local CommScope representative for more information.

- To find out more about CommScope® products, visit us on the web at www.commscope.com
- For technical assistance, customer service, or to report any missing/damaged parts, visit us at <http://www.commscope.com/SupportCenter>
- For information on patents, go to www.cs-pat.com